

T.36 S., R.3 W., W.M.

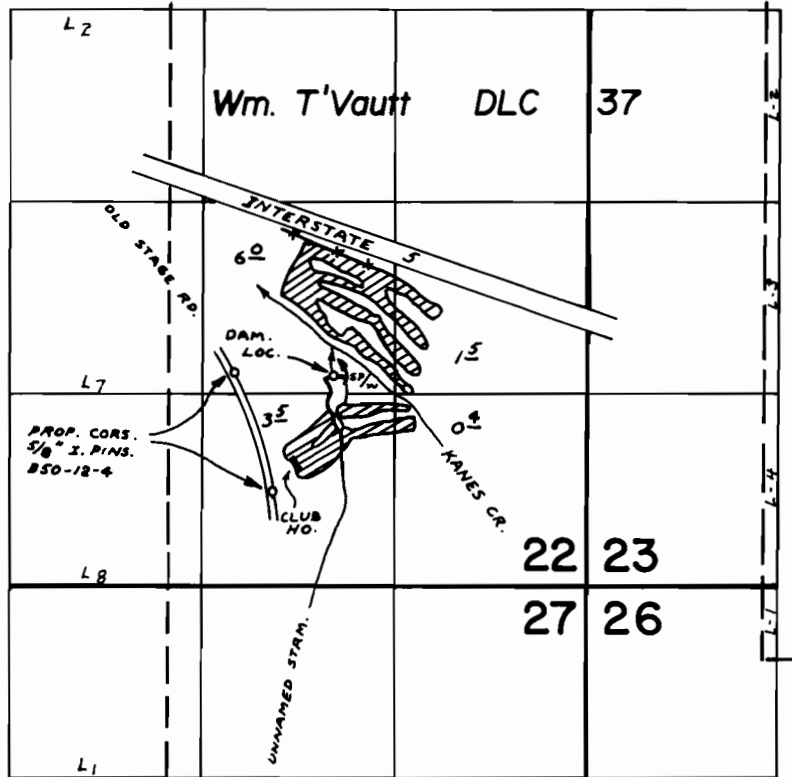

DAM LOC.: 1440' N & 1740' W FROM SE COR. SEC. 22

FINAL PROOF SURVEY UNDER

R-54798 R-6546
54799 41084

Application No. Permit No.
IN NAME OF

HARVEY T. GRANGER & ASSO.

Surveyed NOV. 3 1978, by B. SUND