

T. 36 S., R. 5 W., W.M.

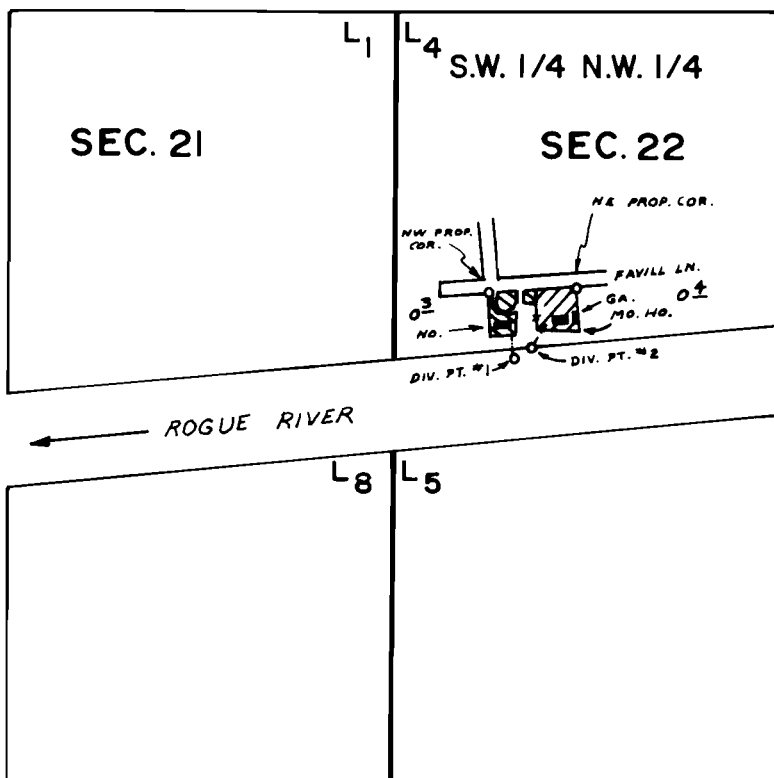

DIV. PT. #1 : 1190'S. & 400'E. FROM NW COR. OF SW 1/4 NW 1/4
 DIV. PT. #2 : 1150'S & 460'E. FROM NW COR. OF SW 1/4 NW 1/4

SCALE : 1" = 660 FT.

FINAL PROOF SURVEY UNDER

Application No. 54534 Permit No. 40901
 IN NAME OF



WILFORD A. & BARBARA CLARK



B.D. & FERN PILLEY

Surveyed OCT. 7 1977, by B. SUND