

T. 36 S., R. 6 W., W.M.

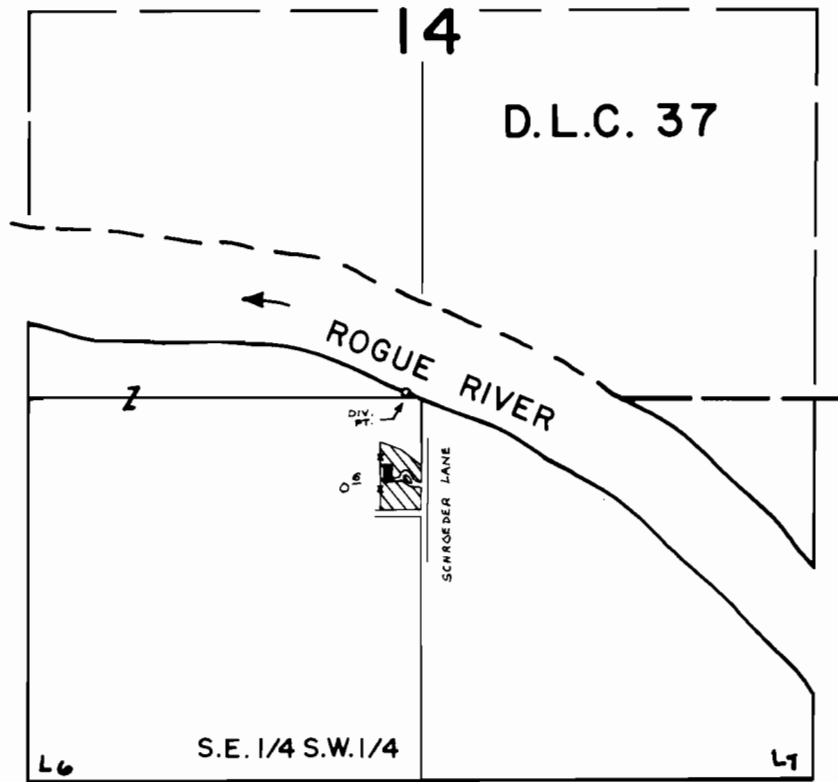

DIV. PT. LOC.: 1335' N. & 50' W. FROM S. 1/4 COR. SEC. 14.

SCALE : 1" = 660'ft.

**FINAL PROOF SURVEY**  
UNDER

Application No. 52073 Permit No. 39240  
IN NAME OF

*Walter R. & Leona A. Gehring*

Surveyed NOV. 8 1977, by B. SUND

D.H.M.

P.T.S. - 1977-14 - B