

T.36 S., R.7 W., W.M.

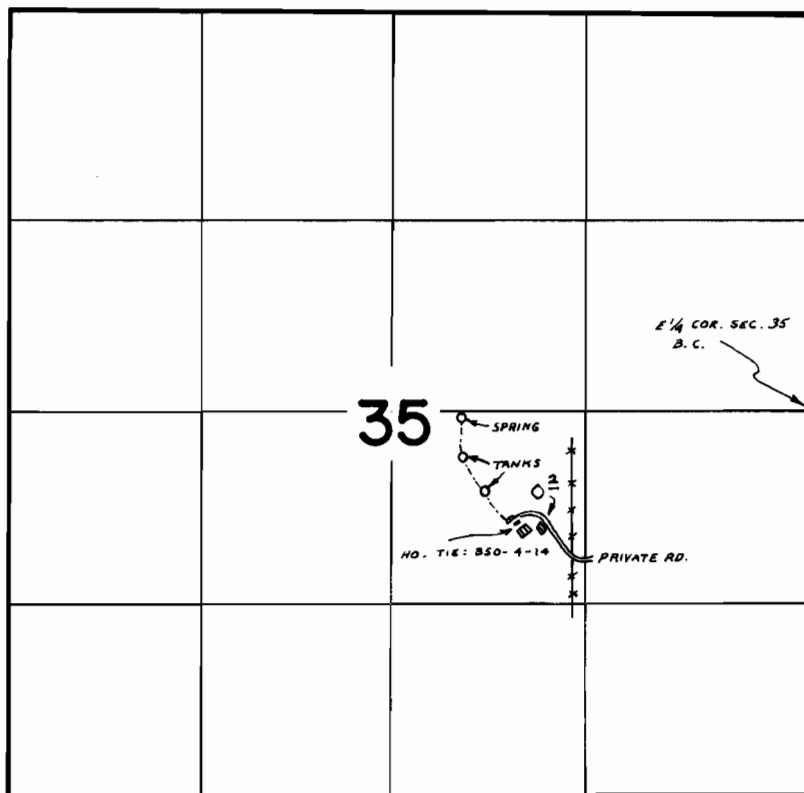

SPRING LOC.: 40'S. & 2410' W. FROM E. 1/4 COR. SEC. 35

FINAL PROOF SURVEY
UNDER

Application No. 50442 Permit No. 38097
IN NAME OF

CALVIN C. PERKINS

Surveyed NOV. 15 1977, by B. SUND

B50-4-14 &
P.T.S.-1977-14-B