

T.2N. R.33E. W.M.

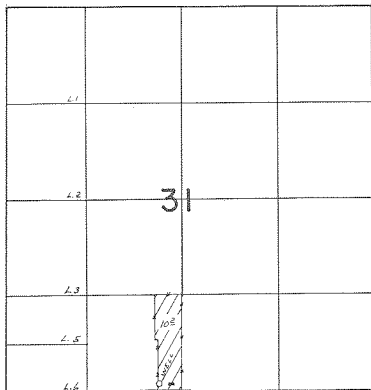

WELL LOC. 120' N. & 320' W. FROM S 1/4 COR. SEC. 31

FINAL PROOF SURVEY
 UNDER

Application No. G-6900... Permit No. G-6428.
 IN NAME OF

..... GENE SIMMONS

Surveyed MAY 3... 1977., by L.H. NUNN.....