

T. 13 S. R. 5 W. W. M.

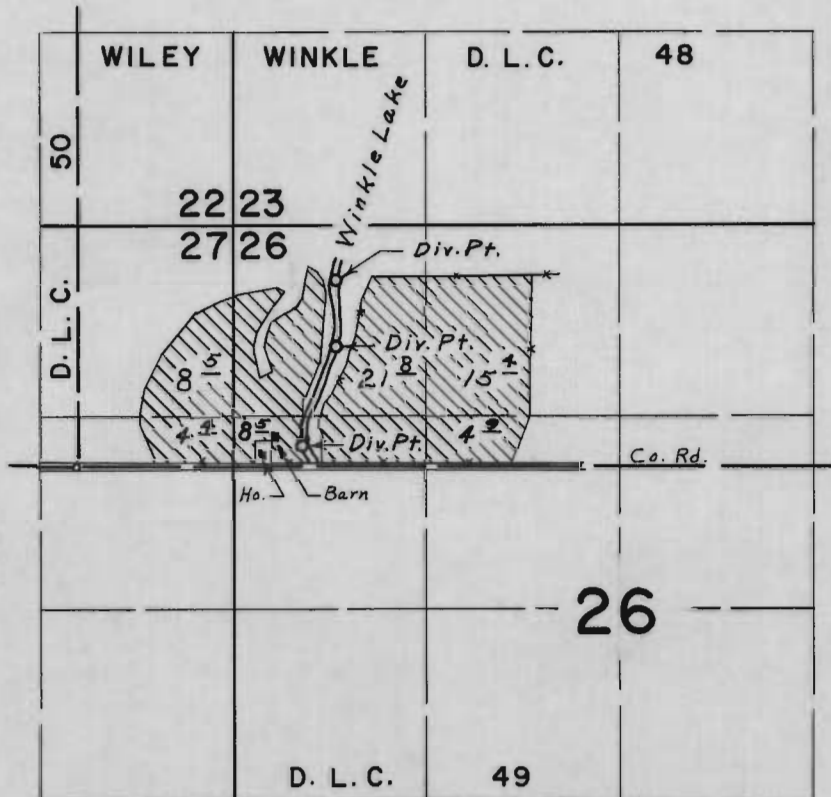

Div. Pts. located 1260' N. & 1760' E.; 820' N. & 1760' E.; 130' N. & 1530' E.; all from S.W. Cor. Wiley Winkle D.L.C. 48

FINAL PROOF SURVEY UNDER

Application No. 42126 Permit No. 31508
IN NAME OF

ROSE IRENE & MORRIS MILTON McDANIEL

Surveyed Oct. 31, 1969, by L. E. Gould