

T.22½23S. R.5½6W. W.M.

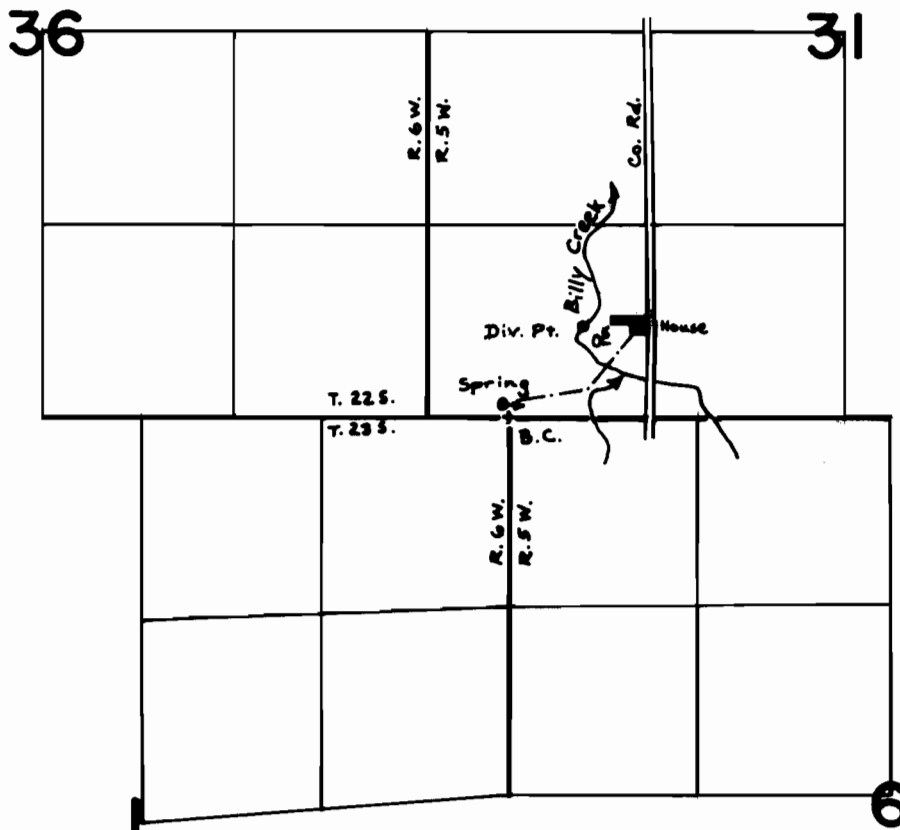

Div. Pt. Located: 640' N ½ 530' E; Spring Located: 100' N ½ 50' W  
both from the NW cor. of Sec. 6 T. 23 S. R. 5 W. W.M.

SCALE: 4" = 1 mile

**FINAL PROOF SURVEY**  
UNDER

Application No. 55290 Permit No. 41481...  
IN NAME OF

CLARENCE JOHN TRUMP

Surveyed Sept. 25, 1978, by D. Henry.....