

T.36S.,R.5W.,W.M.

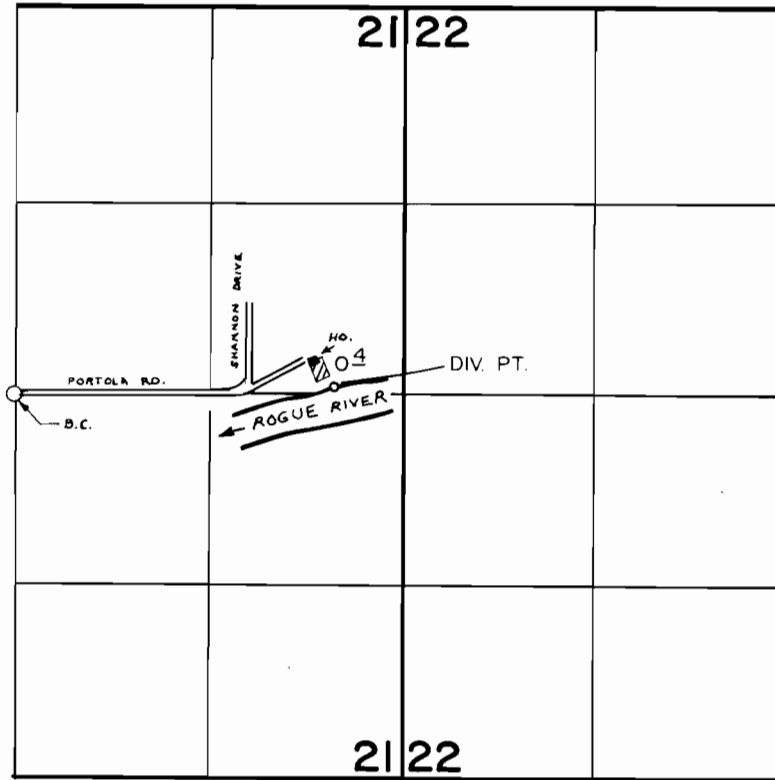

DIV. PT. LOC.: 60' N & 2175' E FROM CENTER SEC. 21

FINAL PROOF SURVEY
UNDER

Application No. 52851... Permit No. 39894...
IN NAME OF

..... C.M. & MABELLE H. INMAN

Surveyed OCT. 7... 1977, by B. SUND