

T. 19S. R. 44 E. W.M.

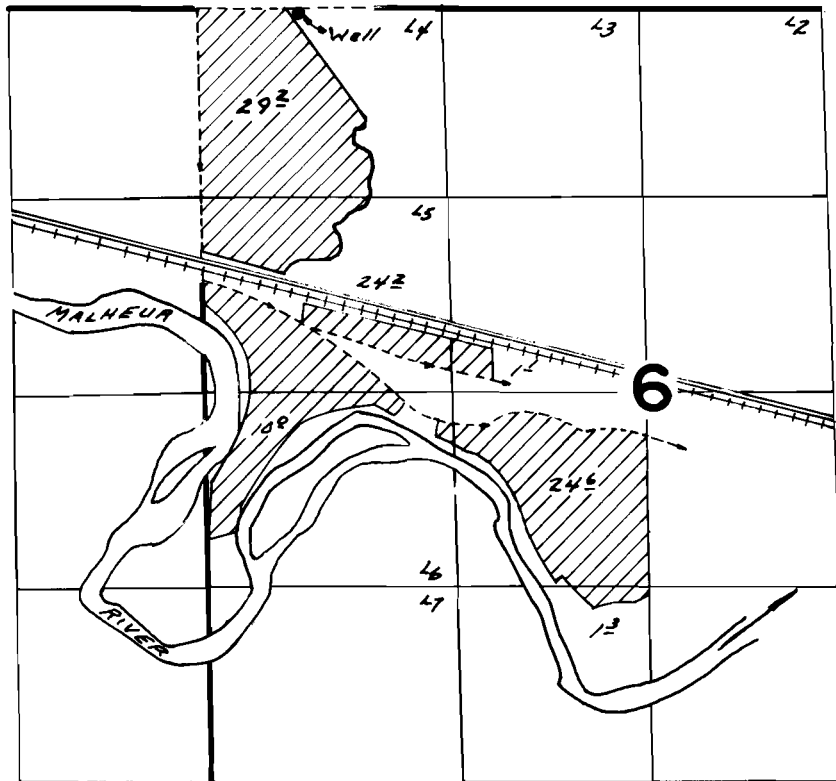

WELL: 40'S & 69'E from the NW Cor. Section 6

FINAL PROOF SURVEY UNDER

Application No. G-2010. Permit No. G-1893...

IN NAME OF

Investment Pool, Inc. -

Gerold & Barbara Knudson

Surveyed APRIL 15 1965, by F.W. ELFERING.