

T.9S. R.3E., W.M.

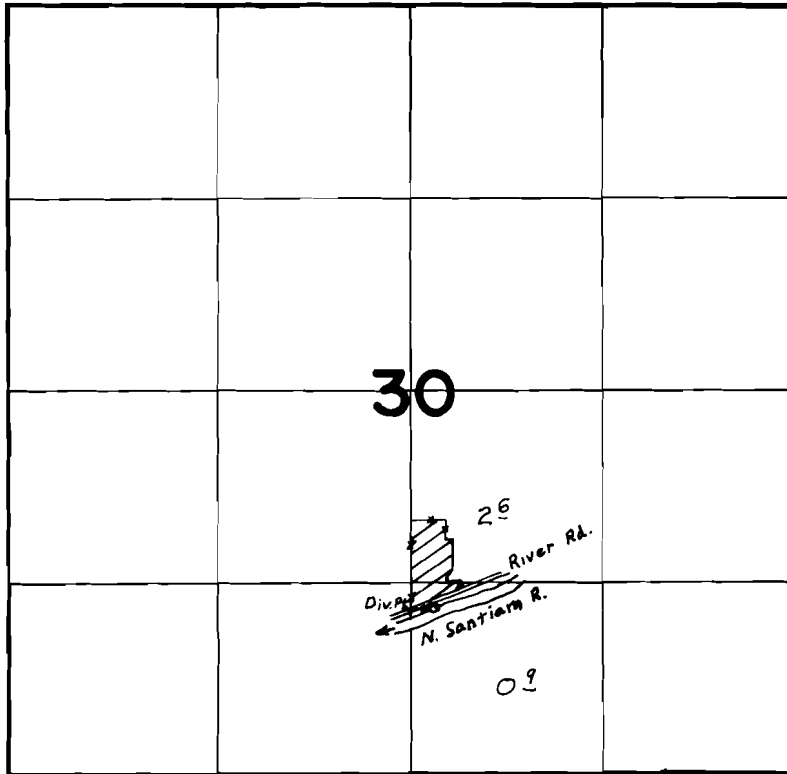

Div. Pt. Loc. 1140' N. & 2470' W. From S.E. Cor. Sec. 30

FINAL PROOF SURVEY
UNDER

Application No. 54146..... Permit No. 40536.....
IN NAME OF

.....GERALD T. PITTAM.....

Surveyed MAY 25, 1978, by S.P. APPLGATE