

T. 3N. R. 29E. W.M.

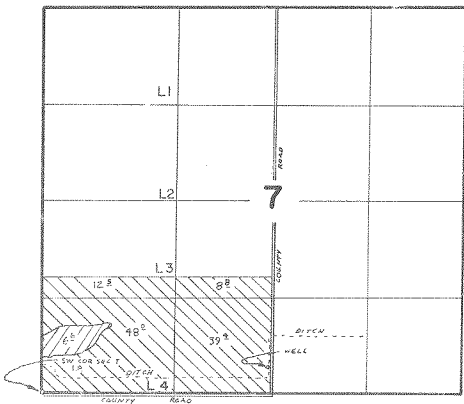

WELL LOCATED 350' N. & 3130' E. FROM SW. COR. SEC. 7



FINAL PROOF SURVEY UNDER

Application No. G-6153... Permit No. G-6097...
IN NAME OF

ROBERT SPIKE

Surveyed NOV...8... 1977, by ...R. BARWIN....