

T. 6N. R. 35E. W. M.

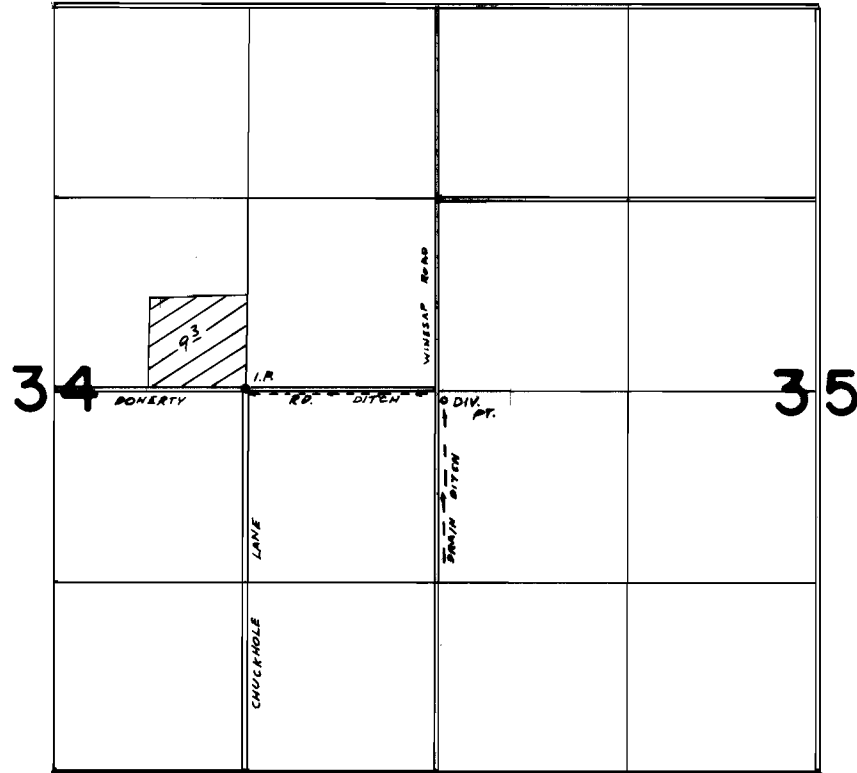

DIV. PT. LOC. 60'S & 50'E FROM W1/4 COR SEC 35

**FINAL PROOF SURVEY**  
UNDER

Application No. 55943... Permit No. 43005...  
IN NAME OF

.....HULETTE JOHNSON.....

Surveyed 9-20 1978, by R. BARWIN.....