

T. 1N. R. 35E. W.M.

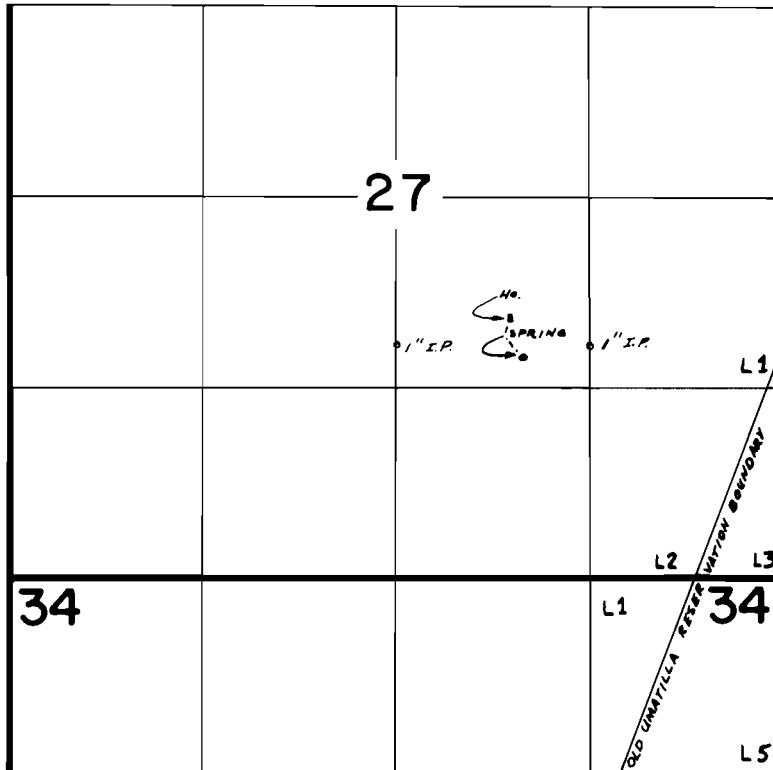

SPRING LOCATED 1820' N. & 1750' W. FROM SE COR. OF SEC 27

FINAL PROOF SURVEY UNDER

Application No. 50673... Permit No. 38281...
IN NAME OF

..... FLOYD W. HARRIS

Surveyed 10-5 1977, by R. BARWIN