

T.4S. R.1E. W.M.

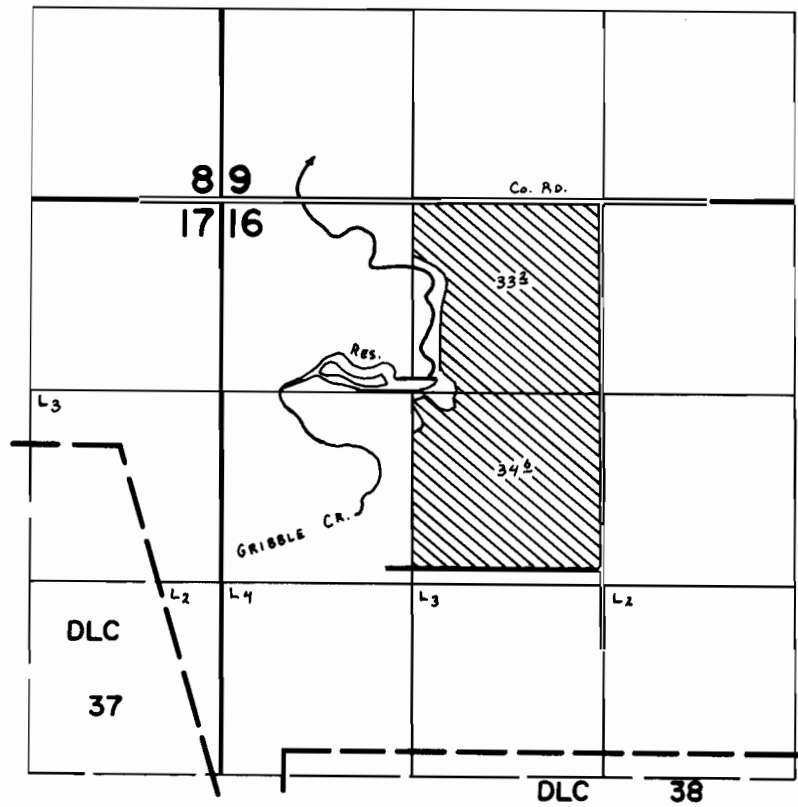

DAM Loc: 1225' S. & 1180' W. fr. N. 1/4 Cor. Sec. 16.

FINAL PROOF SURVEY UNDER

Transfer No. T-3732

R-56219

R-6598

Application No. 56220.. Permit No. 41588.....

IN NAME OF

ERNEST H. PETER

Surveyed Oct. 9. 19.79., by C. L. HUGHES....