

# T.9S. R.27E.W.M.

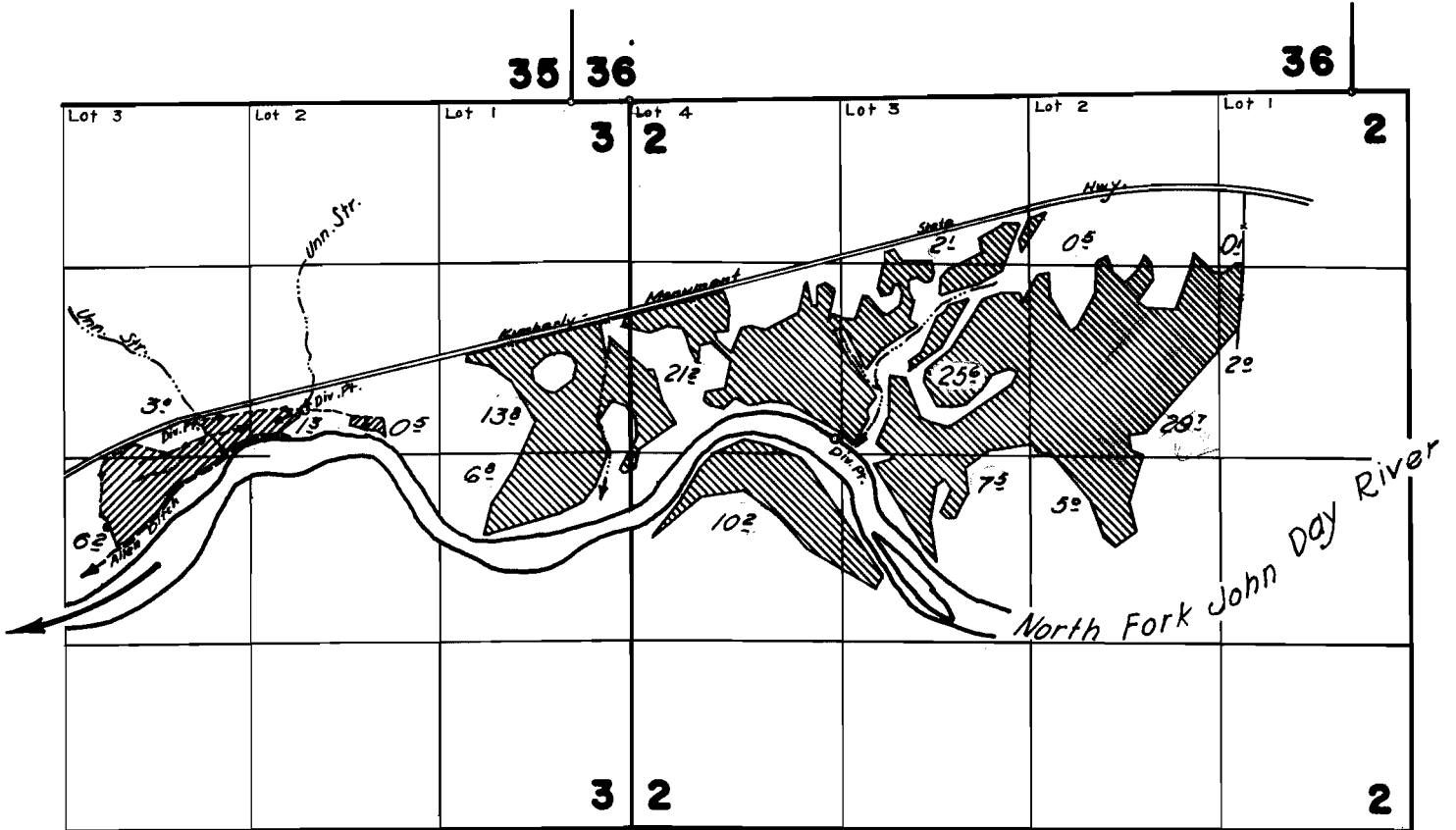

## FINAL PROOF SURVEY UNDER

Application No. 19892 19937 30342 Permit No. 15459 15510 23868

IN NAME OF  
**CLARA C. FLOWER**  
**LEO L. & CLARA C. FLOWER**

Surveyed *October 27 1949*, by *H. V. Gaffman*  
*August 30-31, 1961* by *R. Jackson*