

T. 1N & 1S. R. 26E. WM

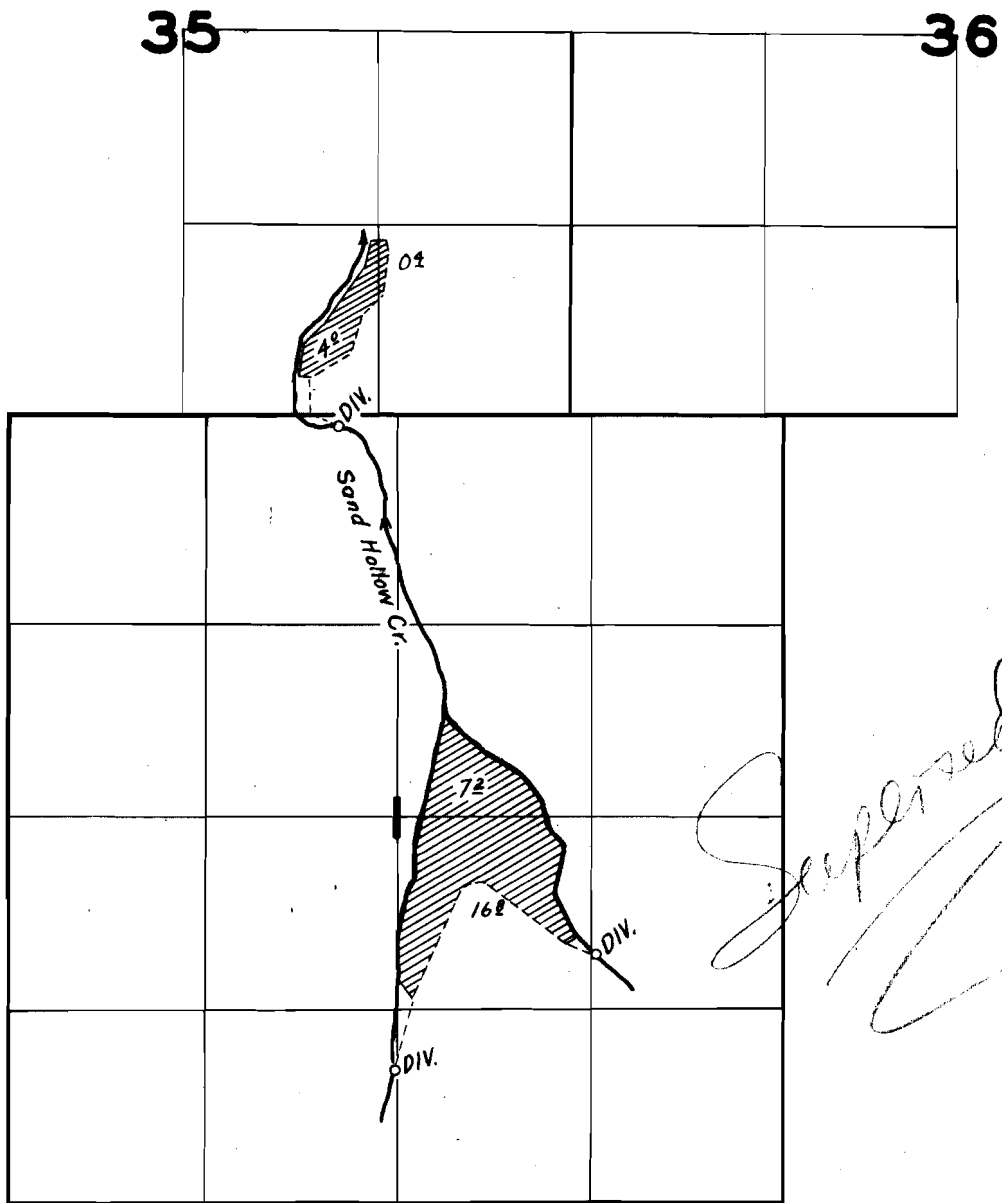

FINAL PROOF SURVEY

UNDER

Application No. 21582 Permit No. 16260

IN NAME OF

O.W. Cutsforth

Surveyed Apr 20 19 47, by J.E. Bunnell

T. IN. & IS. R. 26 E. W. M.

35

36

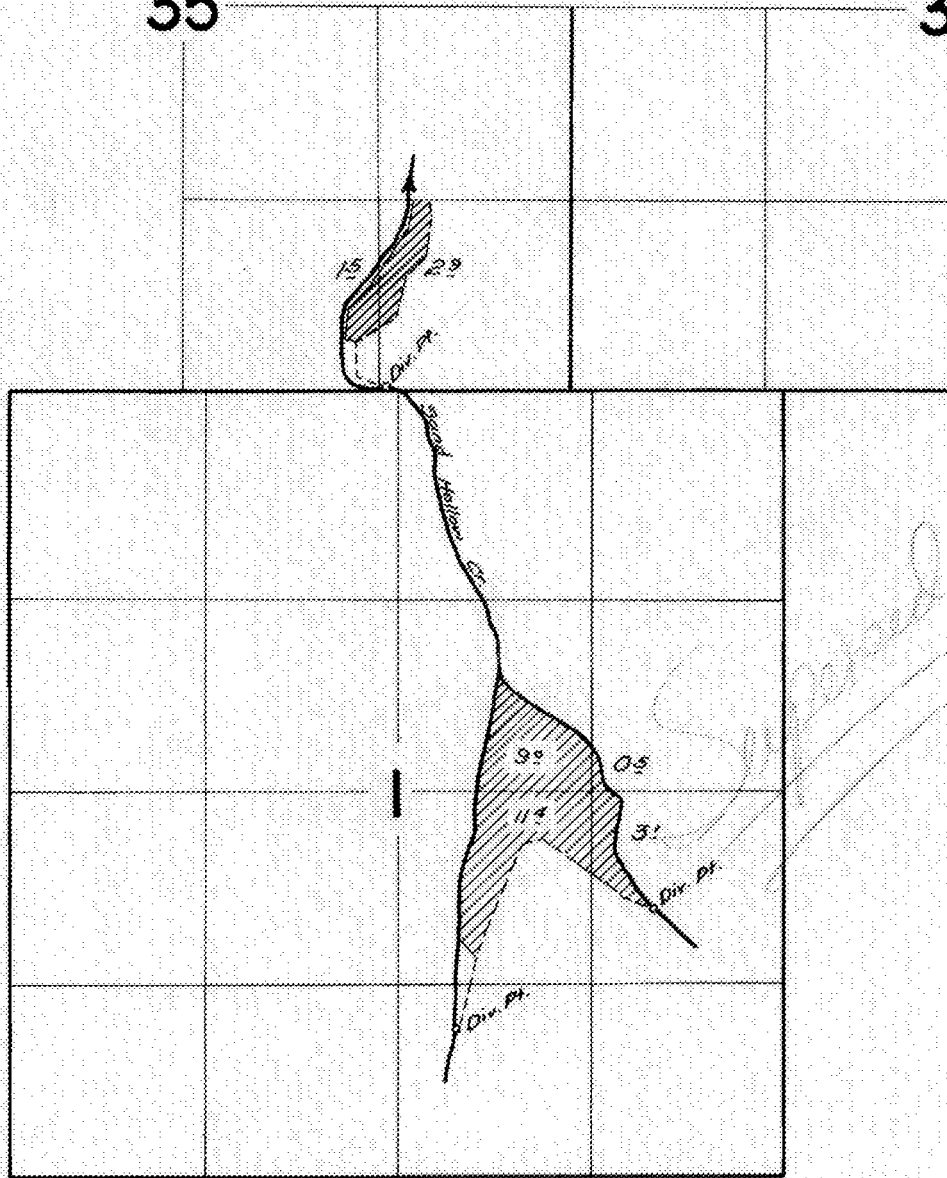

FINAL PROOF SURVEY
UNDER

Application No. **21582** Permit No. **16960**
IN NAME OF

O. W. CUTSFORTH

Surveyed April 20 1947, by J. E. Bunnell.
October 10, 1961, by R. H. Jackson

T. 1S & N. R. 26E. W.M.

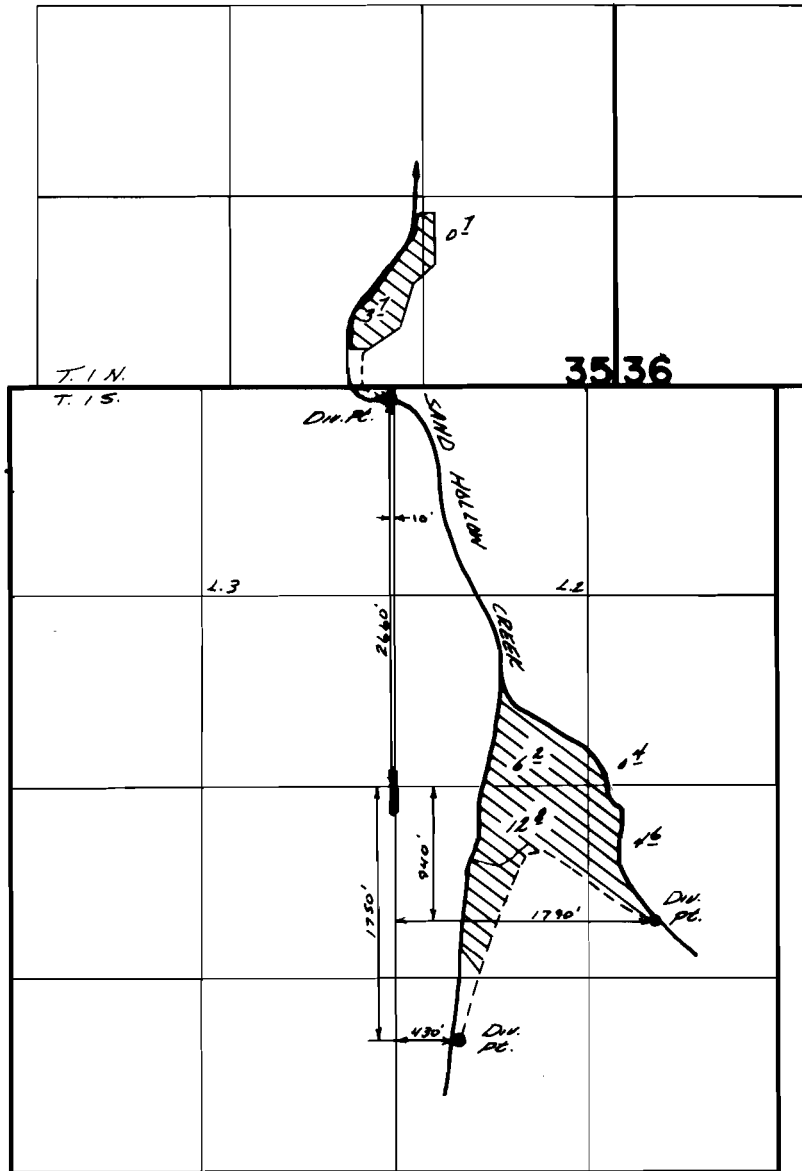

FINAL PROOF SURVEY UNDER

Application No. ~~21582~~.. Permit No. 16960.....
IN NAME OF

.....Q.W. CUTSFORTH.....

Surveyed April..20, 1947., by J.E. Bunnell.....
Oct. 10 1961 by R.H. Jackson

section lines adjusted 1960
PTS-1947A-f 1961K