

# T.1S. R.2W., W.M.

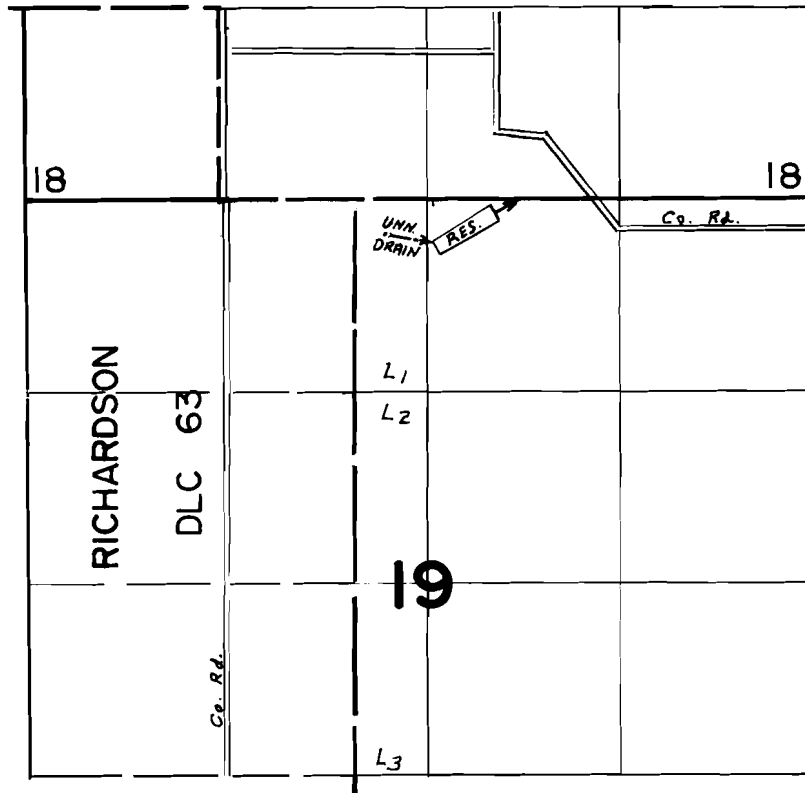

Res. Loc. 80'S. & 960'E. From N.W. Cor. Lot 1 Sec. 19

## FINAL PROOF SURVEY UNDER

R-55458                      R-6618  
Application No. 55459    Permit No. 41826  
IN NAME OF

OREGON BERRY PACKING CO.

Surveyed JUNE 21, 1978., by S.P. APPLGATE