

T.1S. R.2W., W.M.

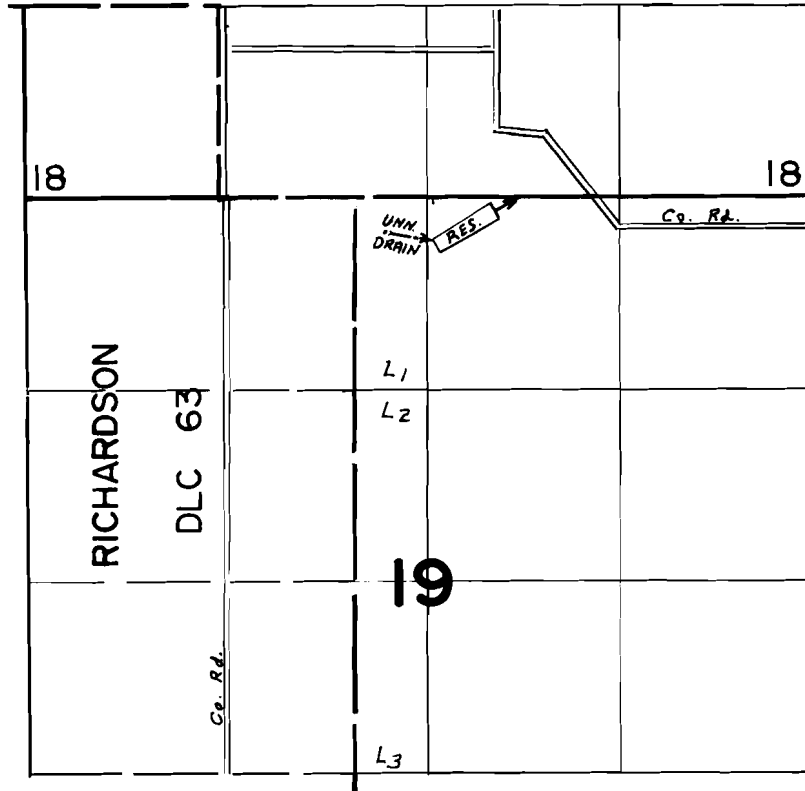

Res. Loc. 80'S. & 960'E. From N.W. Cor. Lot 1 Sec. 19

FINAL PROOF SURVEY UNDER

R-55458 R-6618
Application No. 55459 Permit No. 41826
IN NAME OF

OREGON BERRY PACKING CO.

Surveyed JUNE 21, 1978., by S.P. APPLGATE