

T.9S. R.1E., W.M.

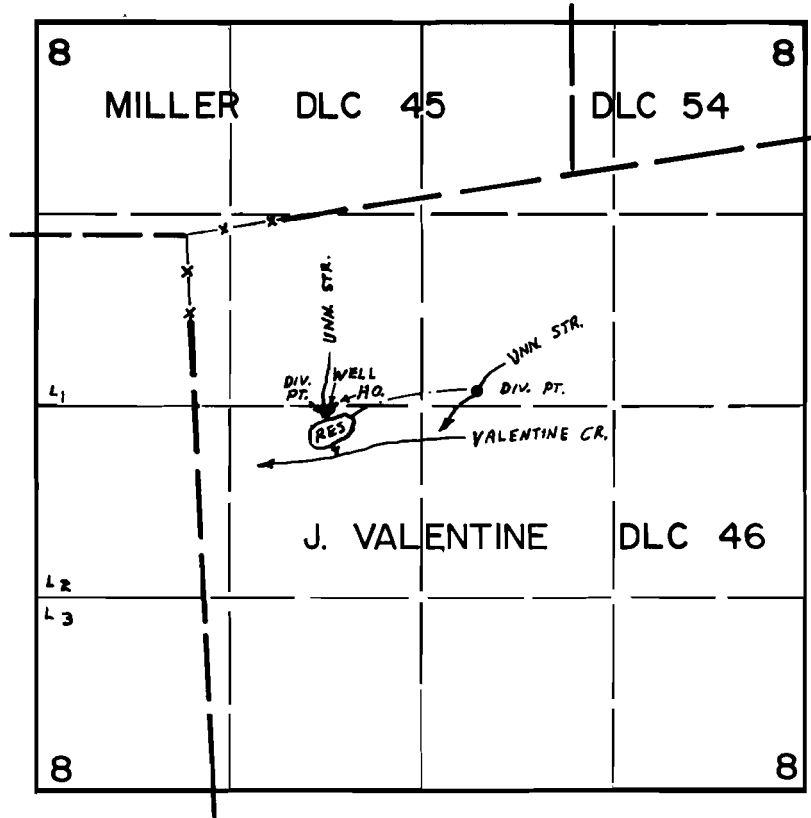

DIV. PTS. LOC. 1220' S. & 970' E.
 1070' S. & 2010' E. ALL FROM N.W. COR. DLC 46
 WELL LOC. 1190' S & 1000' E
 RES. LOC. 1420' S. & 1020' E

FINAL PROOF SURVEY UNDER

R-56399 R-6675
 56400 42102
 Application No. G-8366.. Permit No. G-7590.
 IN NAME OF

.....LEONARD ACKLER.....

Surveyed MAY 23, 1978, by S.P. APPLGATE