

T.6N.R.34E.W.M.

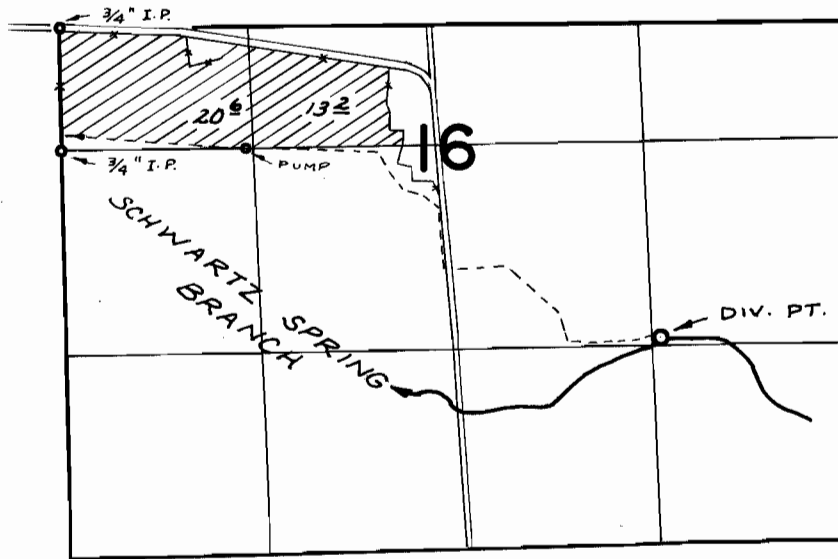

DIV. PT. LOC: 1360'S. & 4070'E. FROM W $\frac{1}{4}$ COR. SEC. 16

FINAL PROOF SURVEY UNDER

Application No. 42898 Permit No. 32059
IN NAME OF

H. A. BACCUS & H. L. YOUNG

Surveyed AUG. 27, 1971, by G. BACA