

G 7380

49823

T. 4N. R. 29E. W.M.

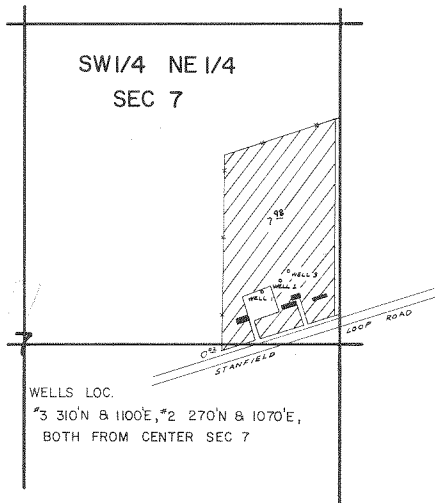

WELLS LOC.

#3 310'N & 1100'E, #2 270'N & 1070'E,
BOTH FROM CENTER SEC 7

SCALE 1"=400'

FINAL PROOF SURVEY UNDER

Application No. G-7845 Permit No. G-7380
IN NAME OF

RAYMOND R. PERKINS

Surveyed 10-5 1978 by R. BARWIN

NE-3MM-174
PTS-1978-P-D V.L.C.