

T. 13S. R. 30E. W.M.

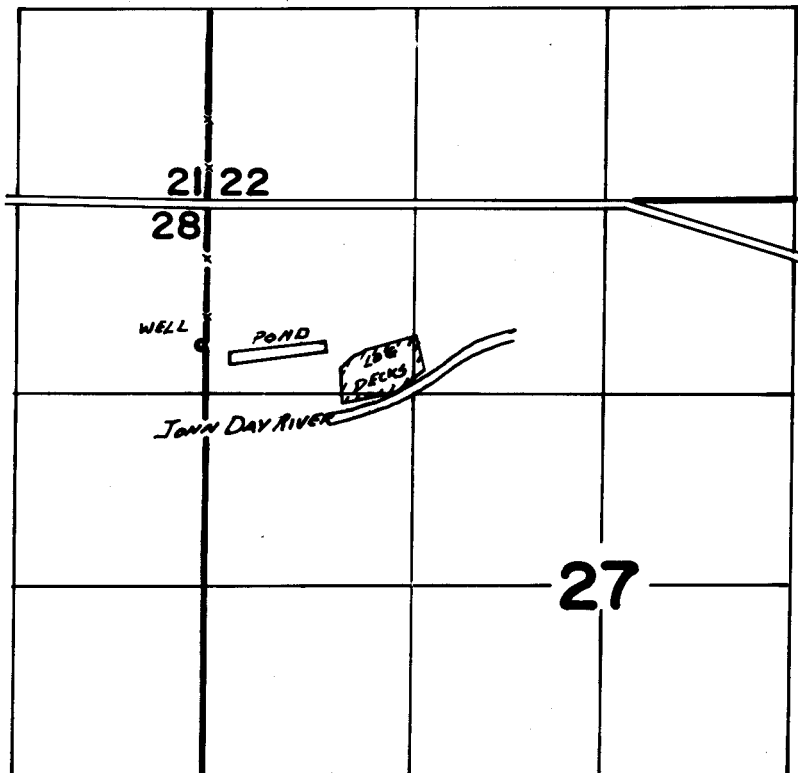

WELL Loc. - 960' S + 32' W FROM NE COR. SEC. 28

FINAL PROOF SURVEY UNDER

Application No. G-6343 Permit No. G-6019
IN NAME OF
EDWARD HINES LUMBER CO.,
GRANT COUNTY DIVISION

Surveyed June 9 1978, by J.S. Donaldson