

# T.1N. R.2W., W.M.

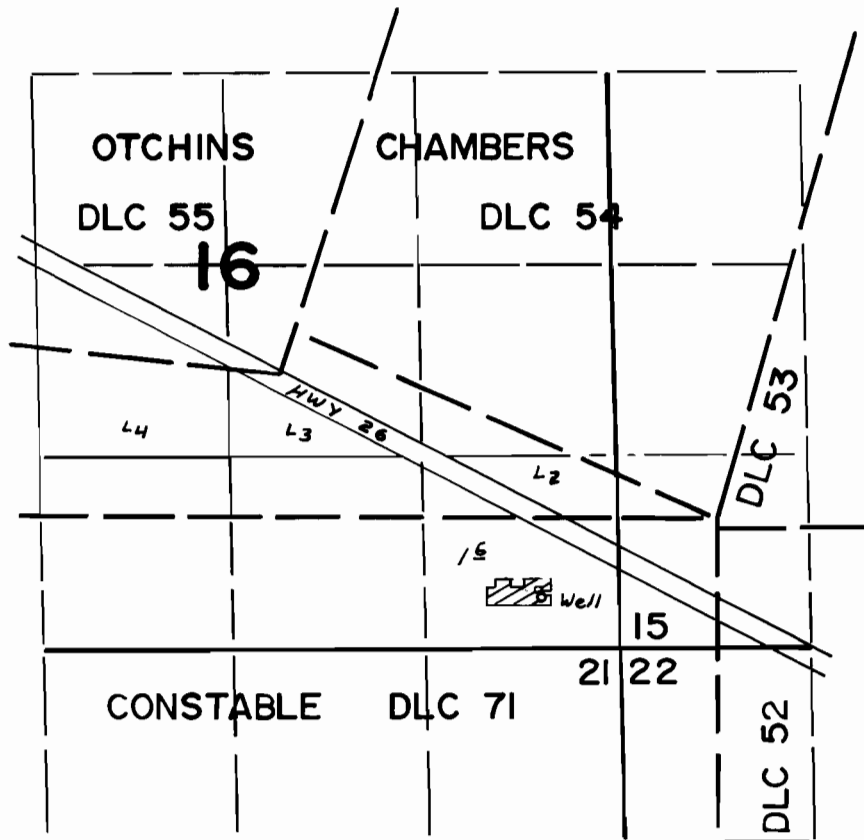

Well Loc: 350' N. & 530' W. From S.E. Cor. Sec. 16

## FINAL PROOF SURVEY UNDER

Application No. G-7527 Permit No. G-6999  
IN NAME OF

ROBERT A. & MARY ANN MARTIN

Surveyed JUNE 26 1978, by S.P. APPLGATE