

T. 5S., R. 5W., W.M.

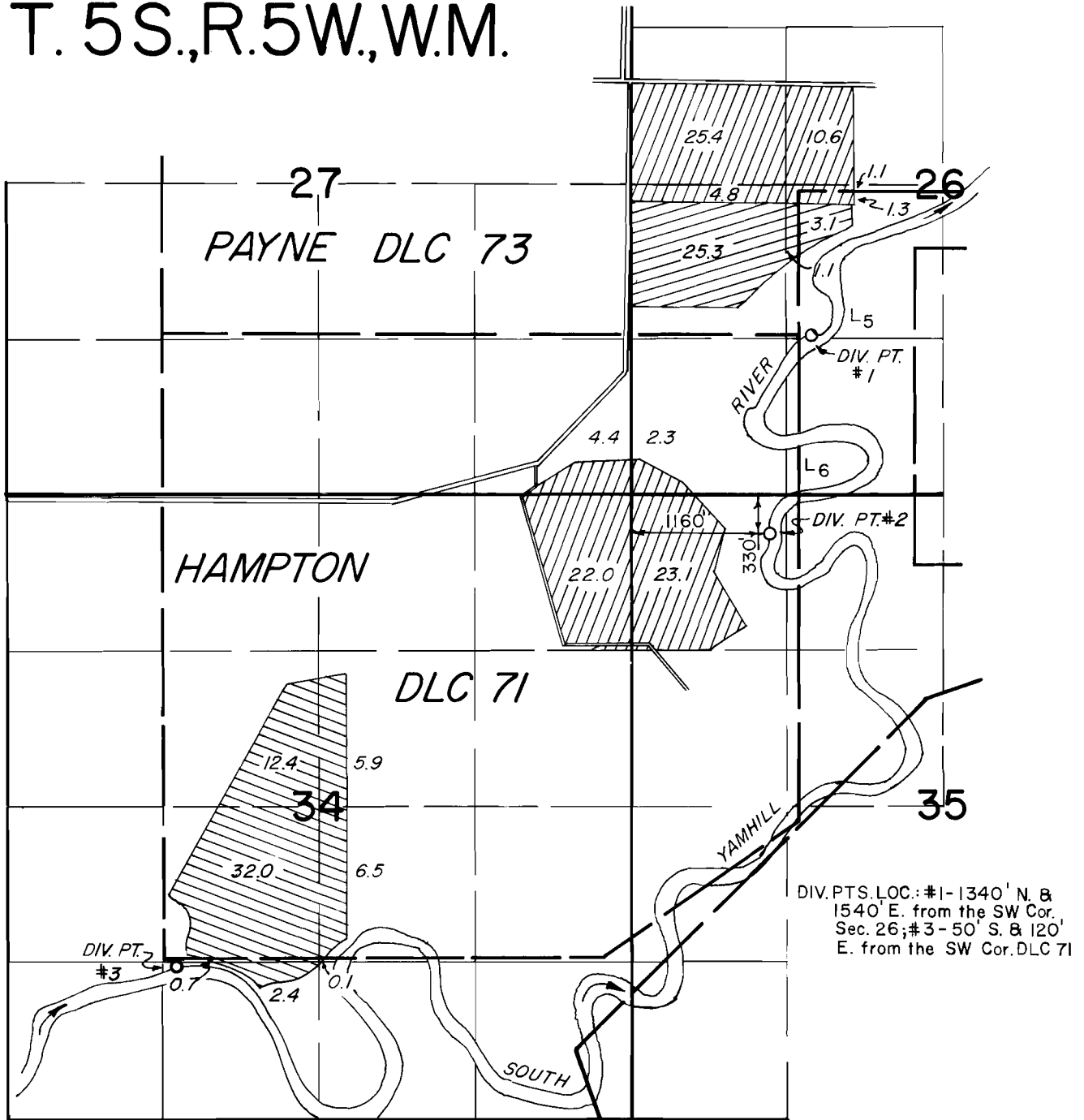

DIV. PTS. LOC.: #1- 1340' N. & 1540' E. from the SW Cor., Sec. 26; #3- 50' S. & 120' E. from the SW Cor. DLC 71

FINAL PROOF SURVEY
UNDER

Application No. 54471 54472 55832 Permit No. 40859 40860 42508

IN NAME OF

CRIMSON WEST FARMS

Surveyed JULY 20, 1977, by *J. Brown*
MAY 31, 1979