

T18S. R2W. WM.

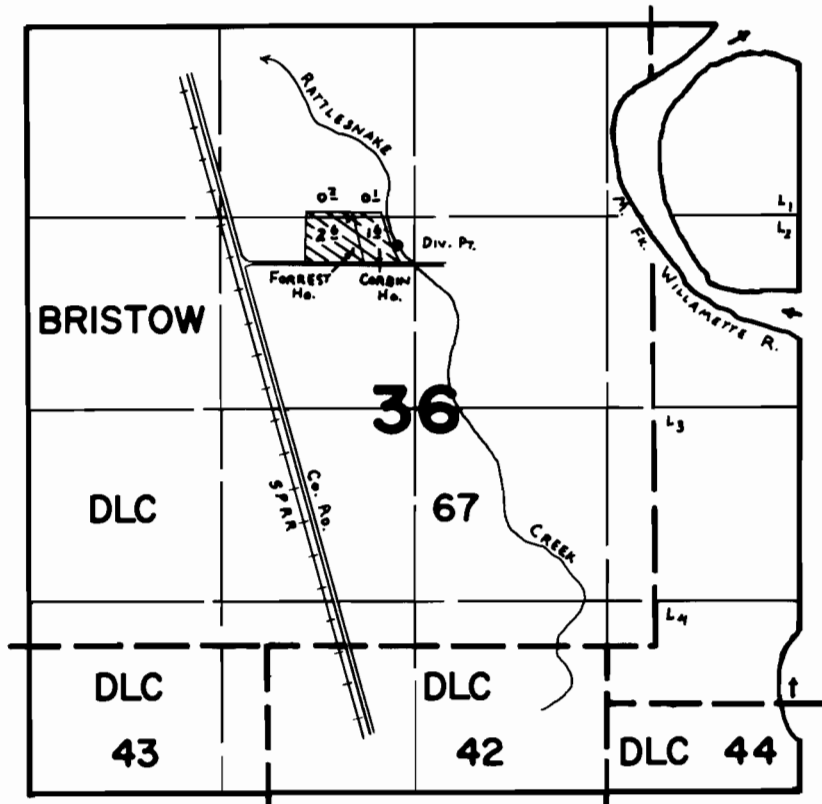

Div. Pt. Loc: 1520'S. & 2530'E. fr. N.W. Cor. Sec. 36.

FINAL PROOF SURVEY UNDER

Application No. 55139 Permit No. 41338
IN NAME OF
NORMAN E. & BONNIE J. CORBIN
EARL D. & FRANCES E. FORREST

Surveyed MAY 23, 1978, by C. L. HUGHES