

T16S. R2E. WM.

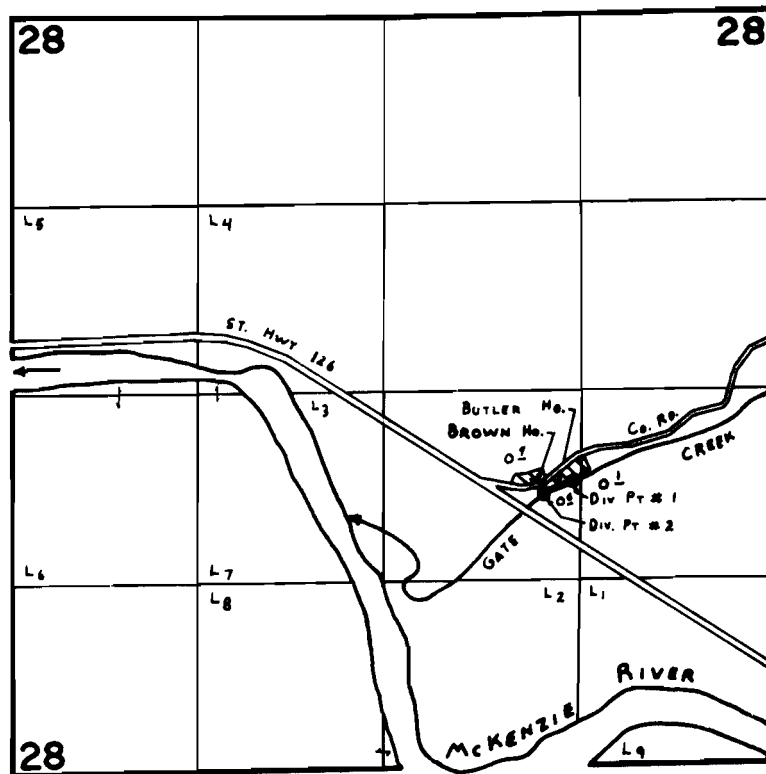

Div. Pts. Loc: #1 - 630' S. & 1360' W. } BOTH FROM E-1/4 COR. SEC. 28.
 #2 - 720' S. & 1560' W. }

FINAL PROOF SURVEY UNDER

Application No. 56251... Permit No. 42640.
IN NAME OF

LEROY O. BUTLER & OSCAR H. BROWN

Surveyed MAY 25, 1978, by C. L. HUGHES.