

TIIS. R4 & 5W. WM.

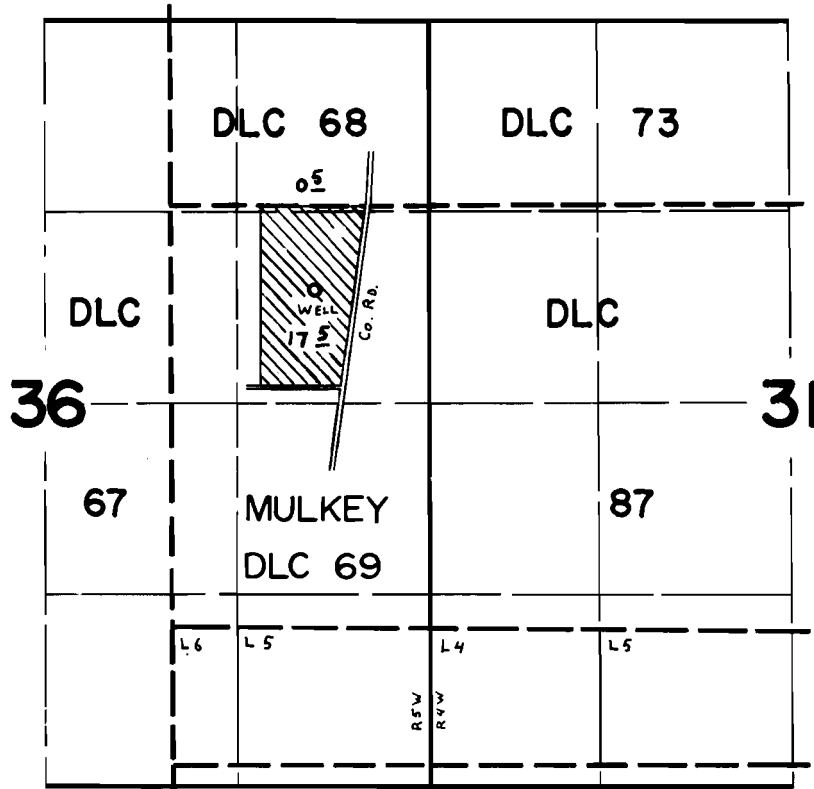

WELL Loc: 570'S & 980' E fr. NW Cor. MULKEY DLC 69.

FINAL PROOF SURVEY UNDER

Application No. G-8320 Permit No. G-7665
IN NAME OF

MRS. IRMA L. TAYLOR

Surveyed MAY 4 1978, by C. L. HUGHES