

T5S, R7W, WM.

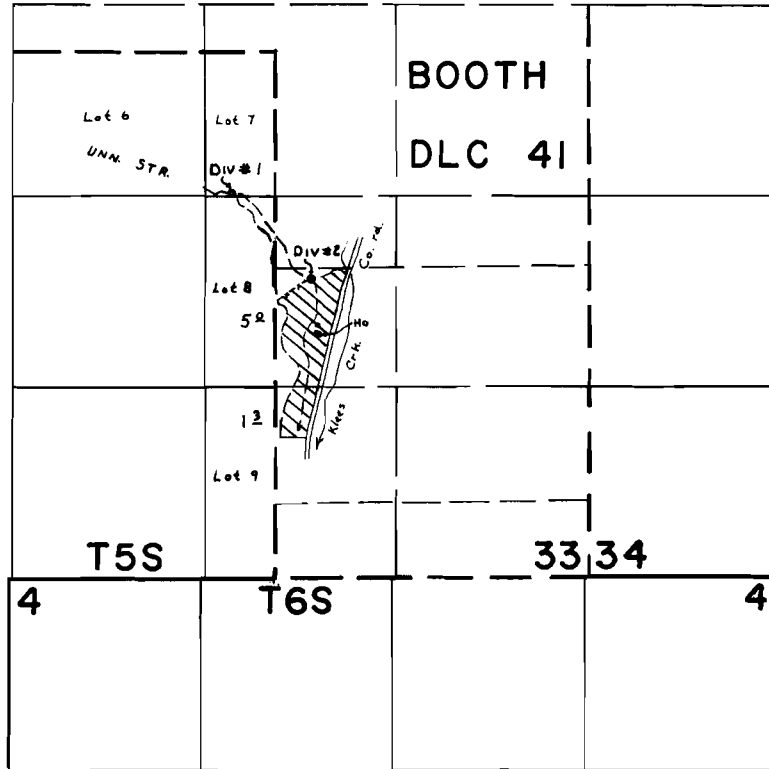

Div Pt #1 LOCATED : 2650' N. & 300' W. fr. SW Cor. DLC 41

Div Pt #2 LOCATED : 2050' N. & 250' E. fr. SW Cor. DLC 41

FINAL PROOF SURVEY UNDER

Application No. 53188 Permit No. 38798

IN NAME OF

CHARLES O. MCBEE

Surveyed SEPT 5 1978, by C.L. HUGHES