

T6S. R7W. WM.

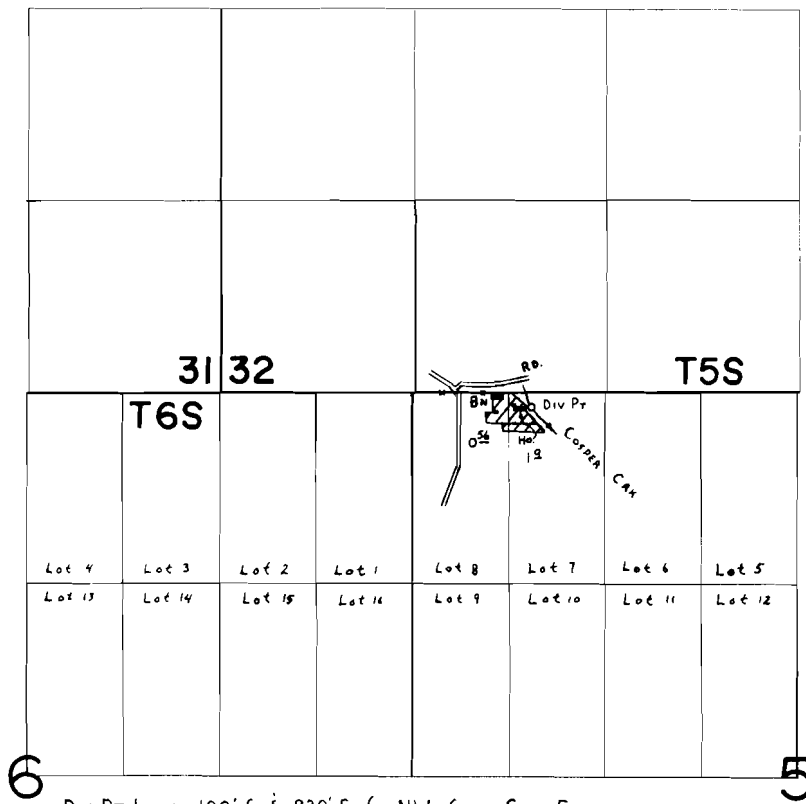

Div Pt Loc: 100' S & 820' E fr. NW. Cor. Sec 5.

FINAL PROOF SURVEY UNDER

Application No. 54192 Permit No. 40613
IN NAME OF

ABNER & JENELLE COBLENTZ

Surveyed SEPT. 7, 1978, by C. L. HUGHES