

T.37&38 S., R.4 W., W.M.

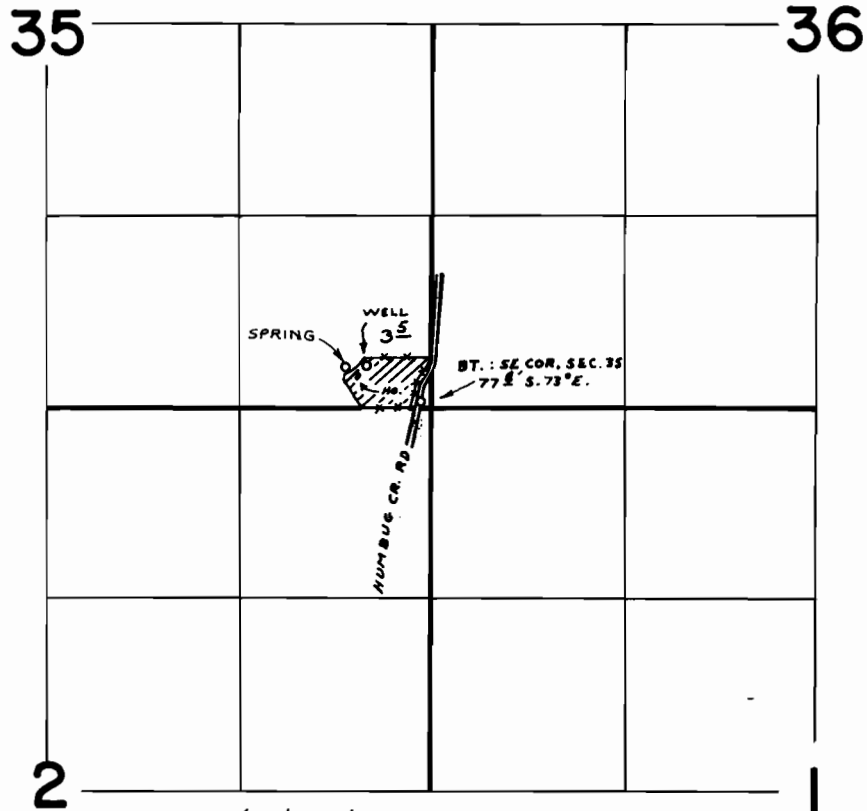

WELL LOC. : 280' N. & 450' W. FROM SE COR. SEC. 35

SPRING LOC. : 280' N. & 500' W. FROM SE COR. SEC. 35

FINAL PROOF SURVEY
UNDER

50746 38326 PRIMARY
Application No. G-7726 Permit No. G-7173 SUPPL.
IN NAME OF

RONALD YARBROUGH

Surveyed JUL. 10 1978 by B. SUND
APR. 5 1979