

T17S. R1E. W1M.

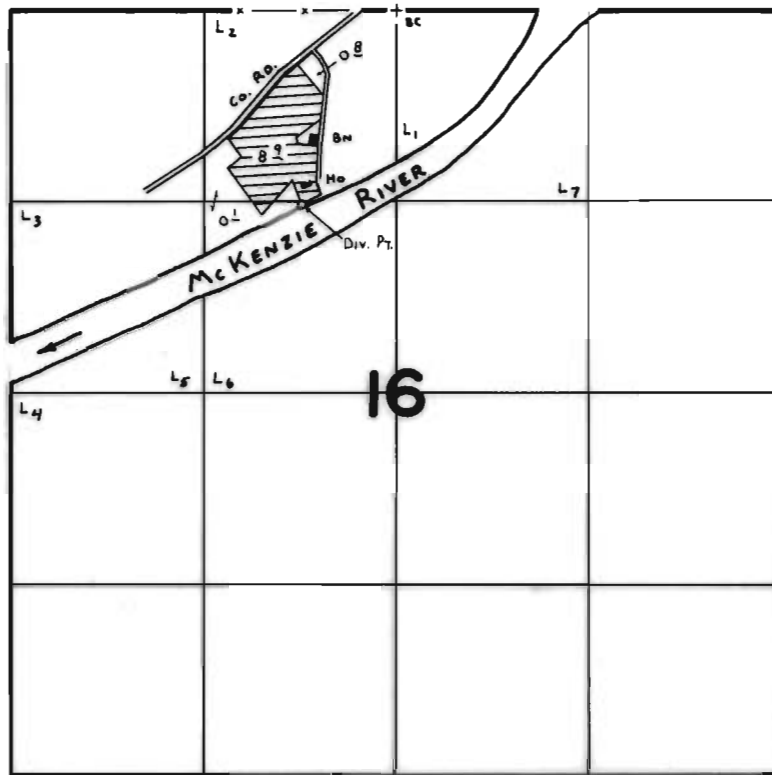

Div. Pt. Loc: 1330' S. & 690' W. fr. N. $\frac{1}{4}$ COR. SEC. 16.

FINAL PROOF SURVEY UNDER

Application No. 52689 Permit No. 39693
IN NAME OF

LORIS WILLIAM FOUNTAIN

Surveyed JULY 18 1978 by C. L. HUGHES