

T13S. R1E. W1M.

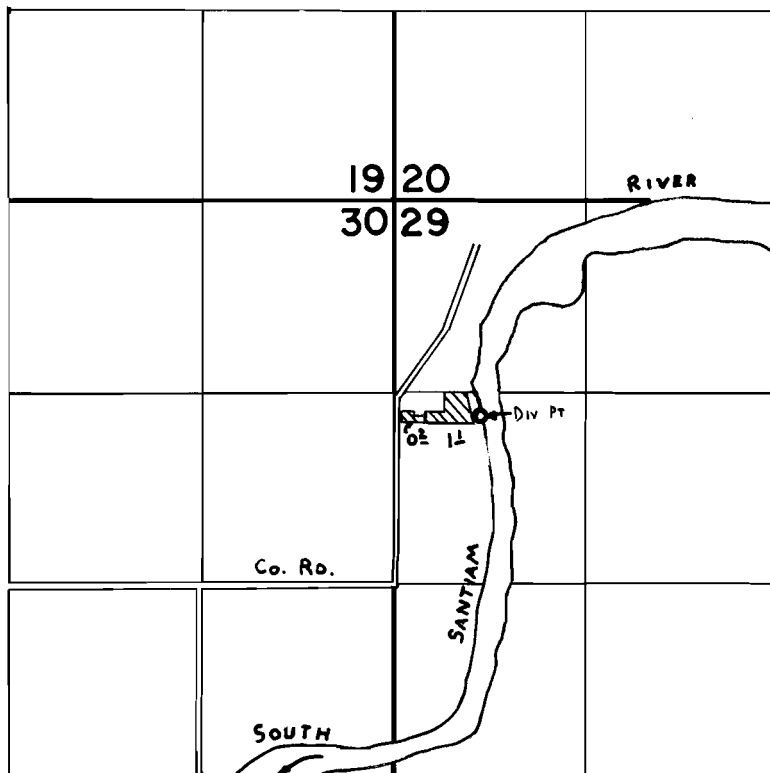

Div. Pt. Loc: 1480' S & 580' E fr. NW Cor SEC 29.

FINAL PROOF SURVEY UNDER

Application No. 55861 Permit No. 41904

IN NAME OF

JOHN W. CARPER

Surveyed MAY 2 1978, by C. L. HUGHES