

T5S. R4W. WM.

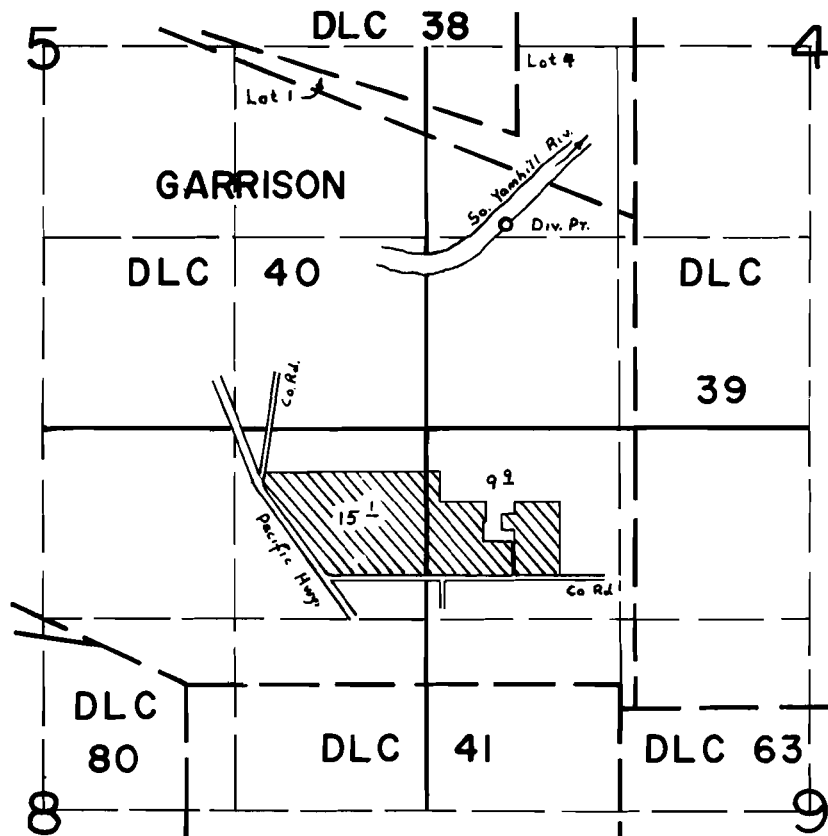

Div Pr Loc: 1400'N. & 550'E. fr SW Cor Sec 4

FINAL PROOF SURVEY UNDER

Application No. 53947 Permit No. 40243
IN NAME OF

CLEMENTS SCHROCK

Surveyed SEPT. 7. 1978, by C.L. HUGHES