

T. 4S. R. 1E. W.M.

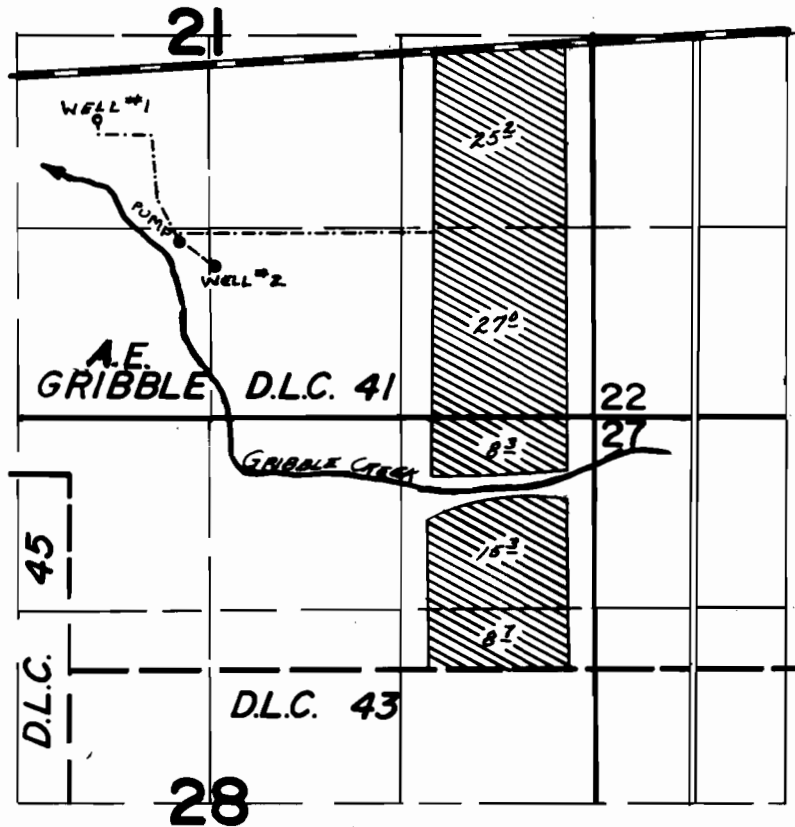

WELLS LOC. - {#1 - 300'S / 1270'E } From NW Cor. GRIBBLE D.L.C. 41
{#2 - 1380'S / 2050'E }

FINAL PROOF SURVEY UNDER

Application No. G-7750 Permit No. G-7198
IN NAME OF

FRANK LAIS

Surveyed MAY 4, 1978, by J.S. Donaldson