

App. 1022

DEVIL'S LAKE IRRIGATION SYSTEM.

Sept 20

1910

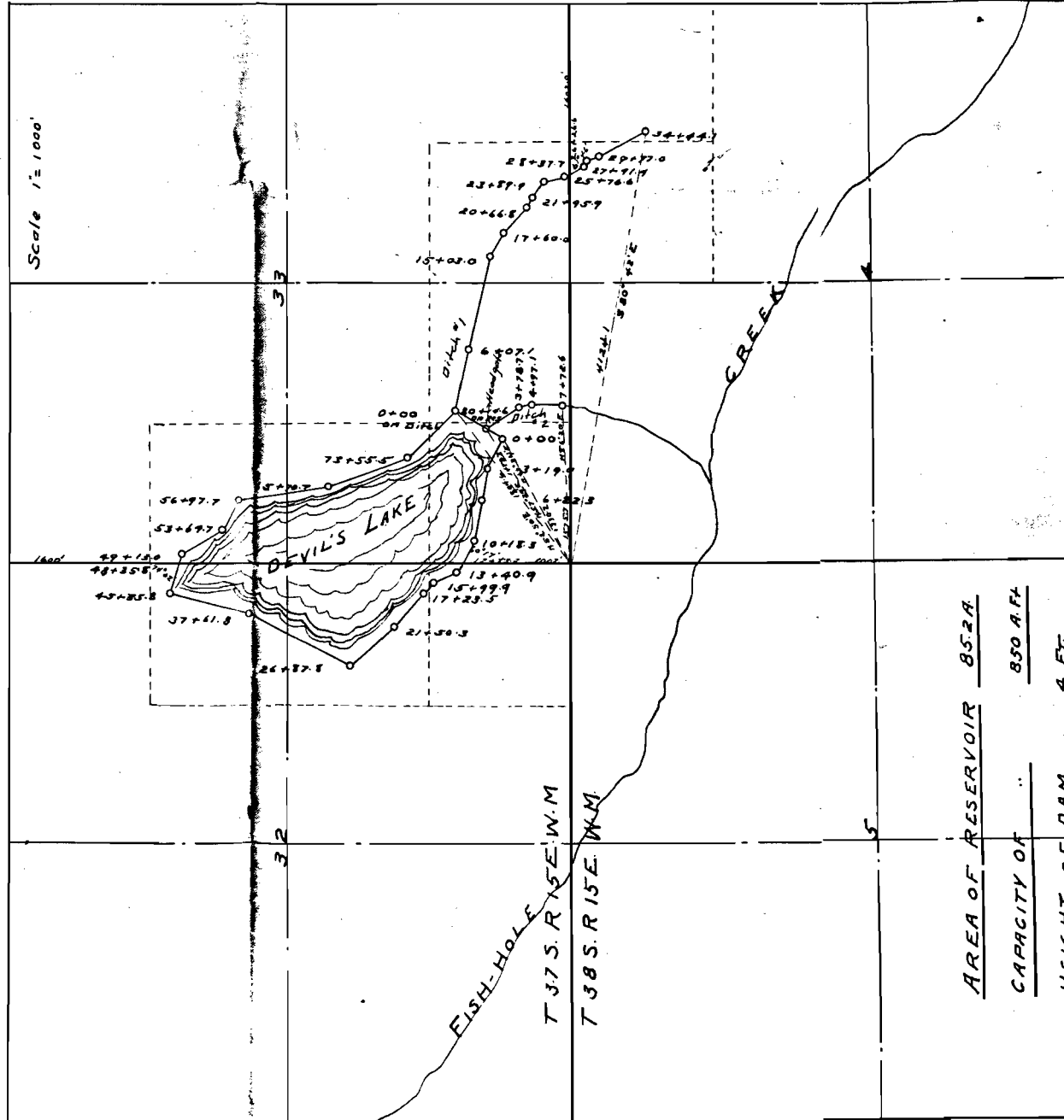

Fish Hole Ck: Misc. (2A) R-68  
503

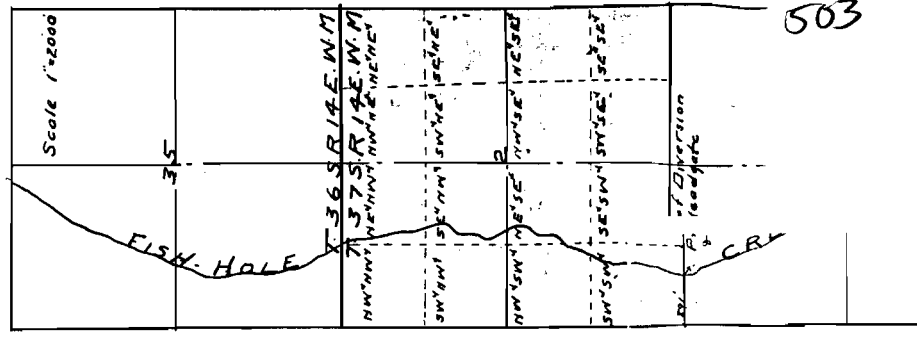

I, Chas. M. Faulkner, of Cedarville, Cal, do hereby Certify that this map was made from notes taken during an actual Survey made by me on Sept 6-7, 1910, and that it correctly represents the marks described in the accompanying application together with the location of streams and other ditches in the immediate vicinity, and has written thereon the area in each smallest legal subdivision which it is proposed to irrigate.

Chas. M. Faulkner  
Surveyor

A

A

Res

DATE, TIME  
FAX NO.  
DURATION  
PAGE(S)  
RESULT  
MODE