

T.2N. R.27E. W.M.

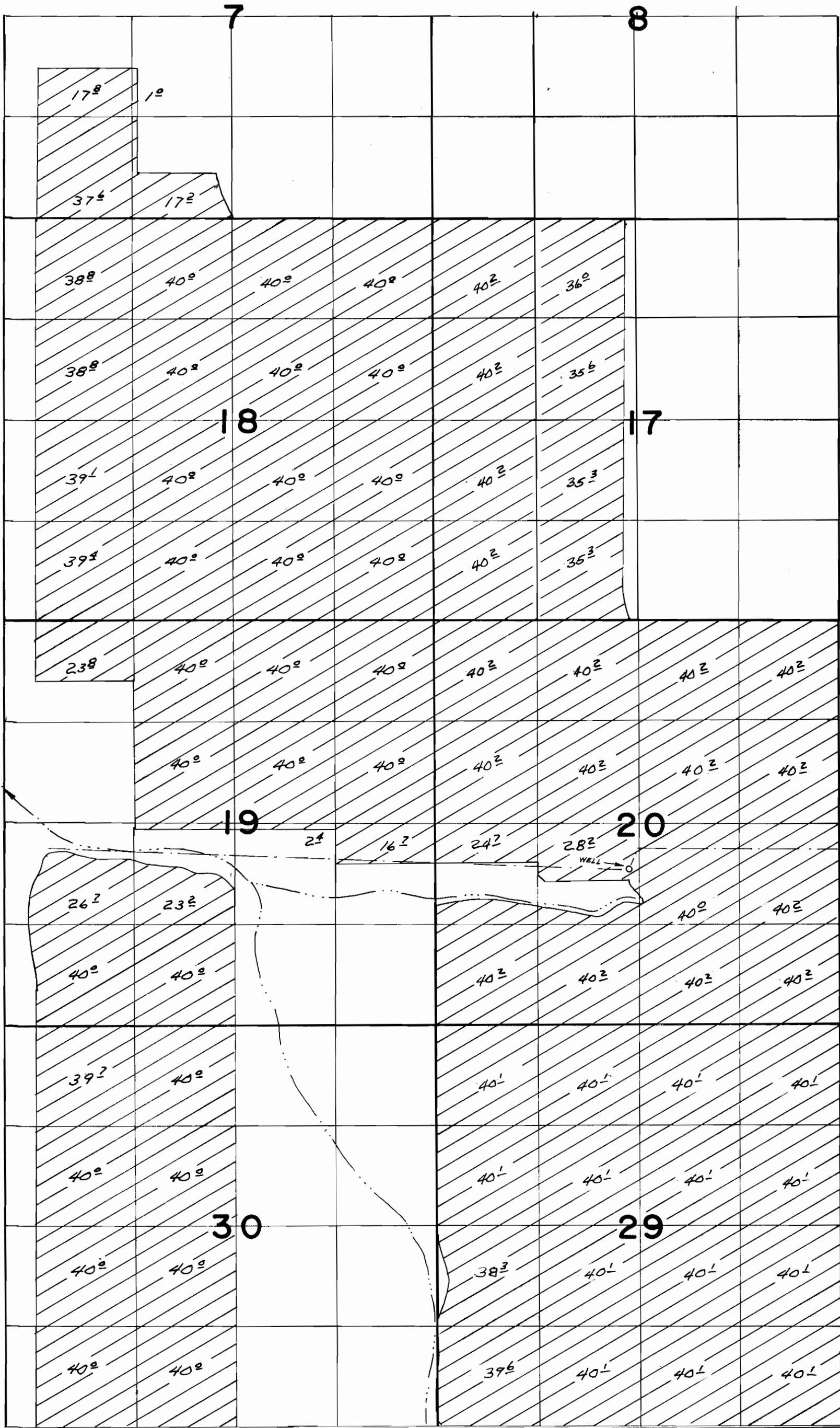

WELL LOC. 600'S & 2550'E FROM W 1/4 COR. SEC. 20

**FINAL PROOF SURVEY**

UNDER

APPLICATION NO. G-4726

PERMIT NO. G-4477

IN THE NAME OF

**STANLEY TUCKER**

SURVEYED SEP 17, 1975 BY L.H. NUNN