

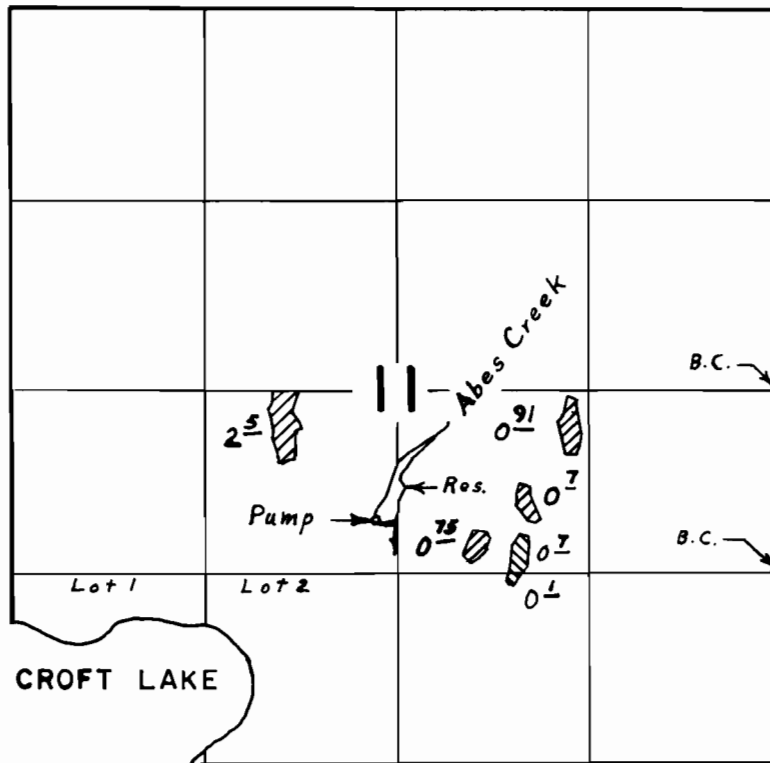

T.30S. R.15W. W.M.



Div. Pt. located 900' S. & 2670' W. from E. $\frac{1}{4}$ Cor. Sec. 11

Supplemental Irrig. 

Primary Irrig. 

FINAL PROOF SURVEY UNDER

R-52601 R-6381
Application No. 52602 Permit No. 39820
IN NAME OF

James E. & Marion M. McFee

Surveyed Aug. 31, 1976, by L. E. Gould