

T2S. R2 & 3E. WM.

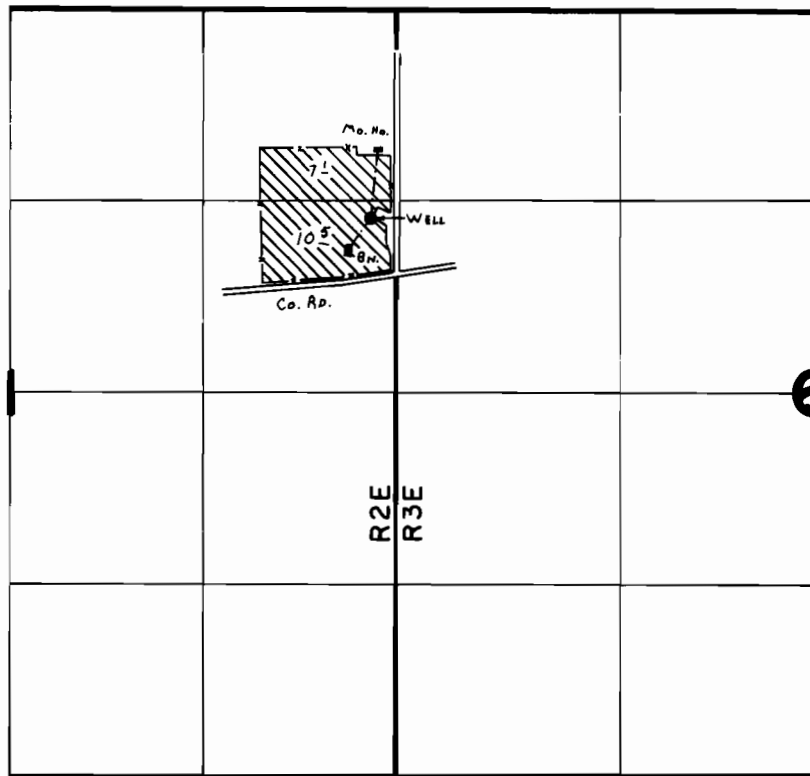

WELL Loc: 1430'S. & 170'W. fr. N.E. Cor. Sec. 1.

FINAL PROOF SURVEY UNDER

Application No. G-8607. Permit No. G-8016.
IN NAME OF

JAMES W. GILBERT

Surveyed OCT. 3. 1978, by C. L. HUGHES.