

# T.5S. R.2&3W., W.M.

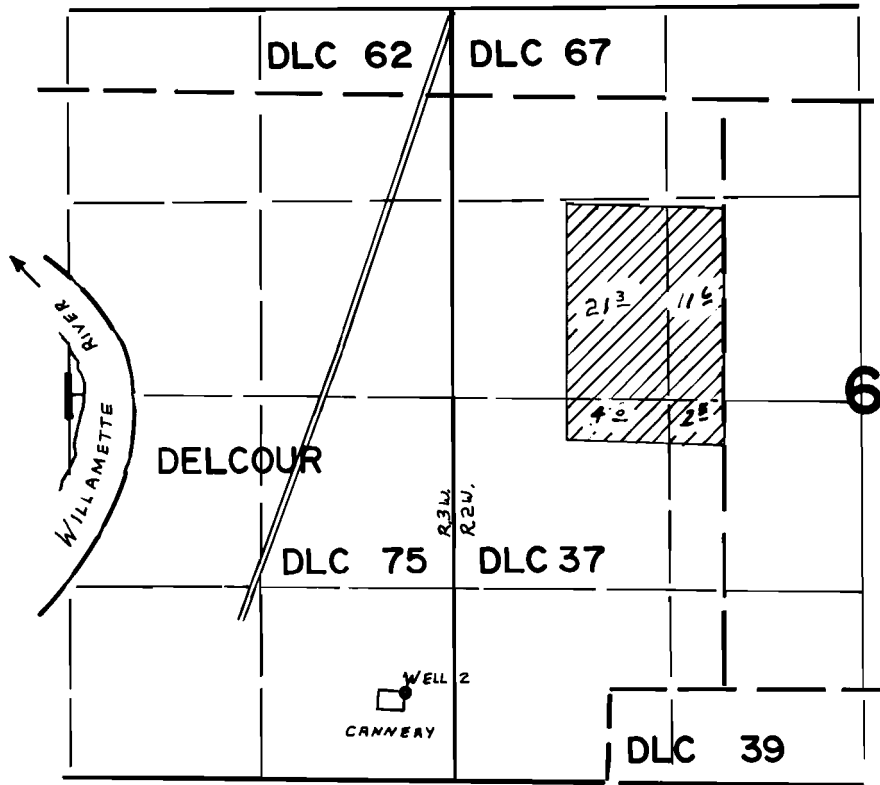

WELL 2 Loc. 4060'S. & 2200'W. FROM N.E. COR. D.L.C. 37

## FINAL PROOF SURVEY UNDER

Application No. G-7976.. Permit No. G-7670..  
IN NAME OF

RIVER BEND FARM

Surveyed JUNE 7, 1979, by L. H. NUNN