

MAP FROM G 8008.

T.1 & 2S. R.12 & 13E. W.M.

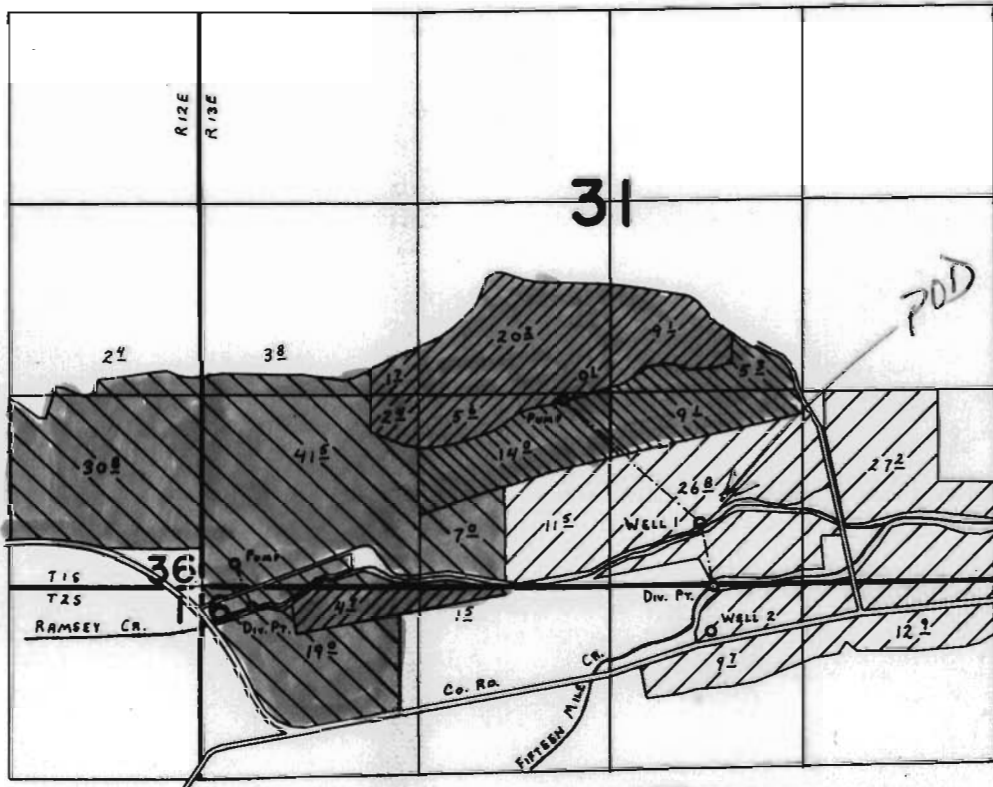

Div. Pts. Loc:

RAMSEY CR - 140'S. & 350'E.
 FIFTEEN MILE CR - 20'N. & 3540'E. } BOTH FROM N.W. COR. SEC. 6

WELLS LOC:

#1 - 430'N. & 3460'E. } BOTH FROM N.W. COR. SEC. 6.
 #2 - 330'S. & 3530'E.

- PRI. IRR. APP. 54189 SUPP. IRR. APP. G-7348, G-8008
- PRI. IRR. APP. 54189 SUPP. IRR. APP. G-7348, G-8008
- SUPP. IRR. APP. G-8008
- SUPP. IRR. APP. G-7348, G-8008

FINAL PROOF SURVEY
 UNDER

54189 40564
 G-7348 G-6778
 Application No. G-8008 Permit No. G-7444
 IN NAME OF

RICK CANTRELL

Surveyed June 26, 1979, by C. L. HUGHES