

T3S. RIW. WM.

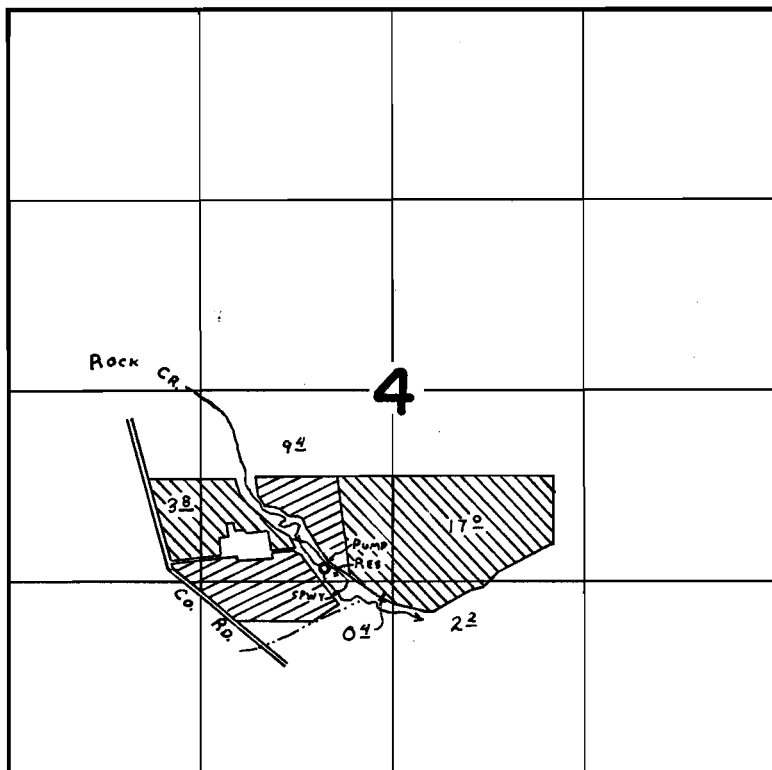

DAM Loc: 1260' N. & 330' W. } BOTH FROM S. 1/4 COR. SEC. 4.
 PUMP Loc: 1410' N. & 470' W. }
 ▨ - CERT. # 22991
 ▩ - APP. # 53455

FINAL PROOF SURVEY UNDER

Application No. R-53454 53455 Permit No. R-6384 39869
 IN NAME OF

JACQUE E. PARSONS

Surveyed AUG. 18 1978 by C. L. HUGHES