

# T3S. R1E. WM.

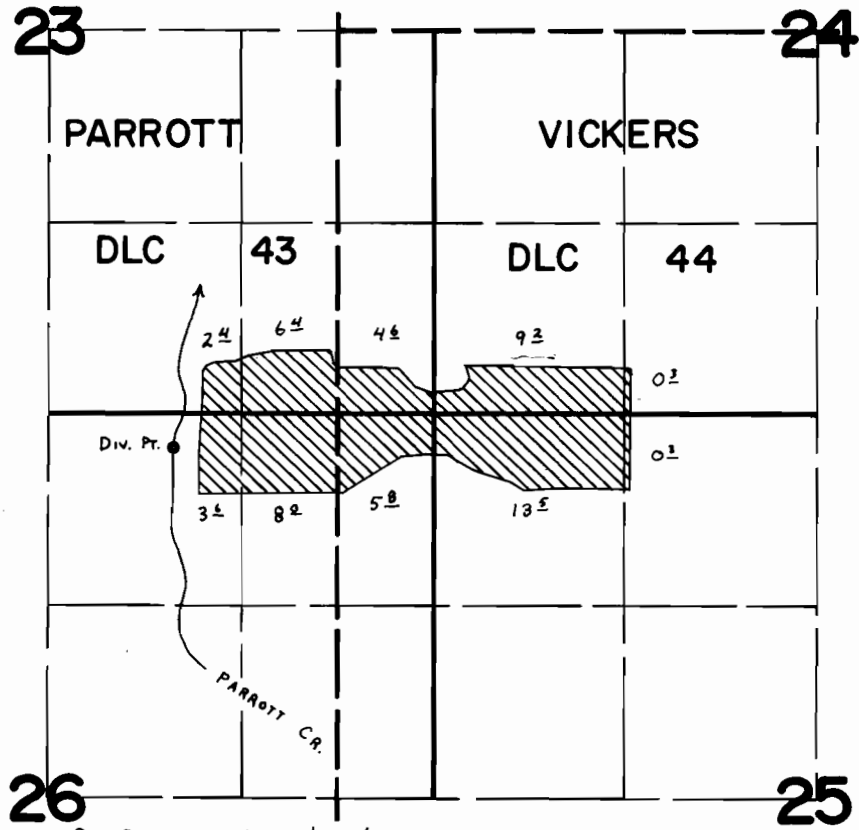

Div. Pt. Loc: 2880'S. & 1120'W. fr. N.W. Cor. VICKERS DLC 44.

## FINAL PROOF SURVEY UNDER

Application No. 52746 Permit No. 39713  
IN NAME OF

JOHN G. EMERY

Surveyed JUNE 7, 1978, by C. L. HUGHES