

T2S. R1E. WM.

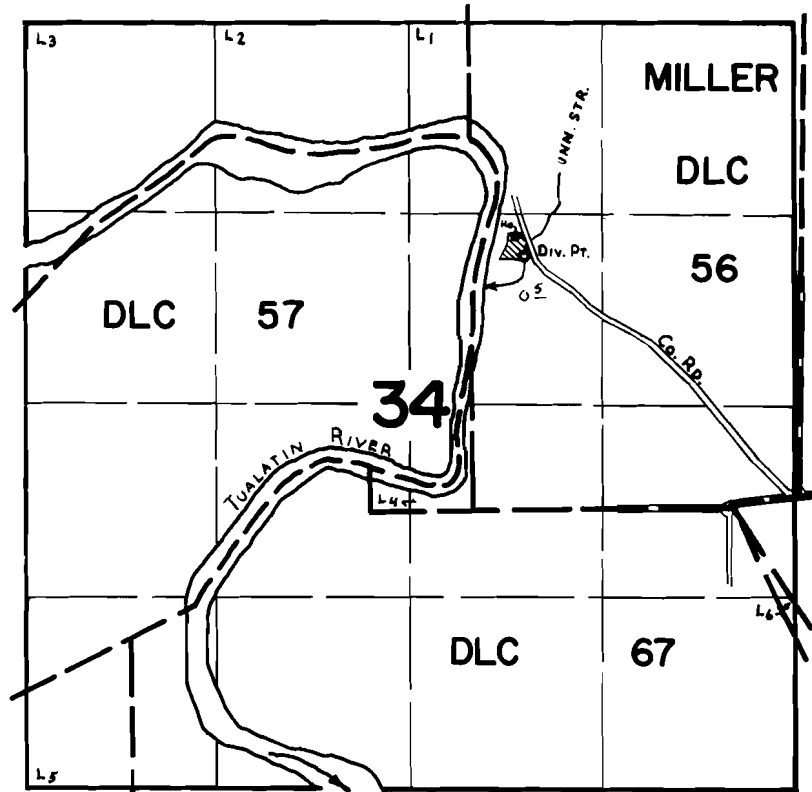

Div. Pt. Loc: 280' S. & 530' W. fr. Cen. of NE 1/4 of Sec. 34.

FINAL PROOF SURVEY UNDER

Application No. 54144 Permit No. 40534
IN NAME OF

HENRY R. ROHE

Surveyed JUNE 8, 1978, by C.L. HUGHES