

MAP

— Accompanying Application of FROGUE RIVER COMMERCIAL ORCHARDS CO
for Permit to appropriate the waters of Antelope, Yankee, Spring, Hawkins,
and Swan Creeks also Springs N°1 to 11 as shown on plat. —

Fred N. Cummings, C.E.
Medford, Oregon

Tp. 36 S. R. 1 E. W. M.

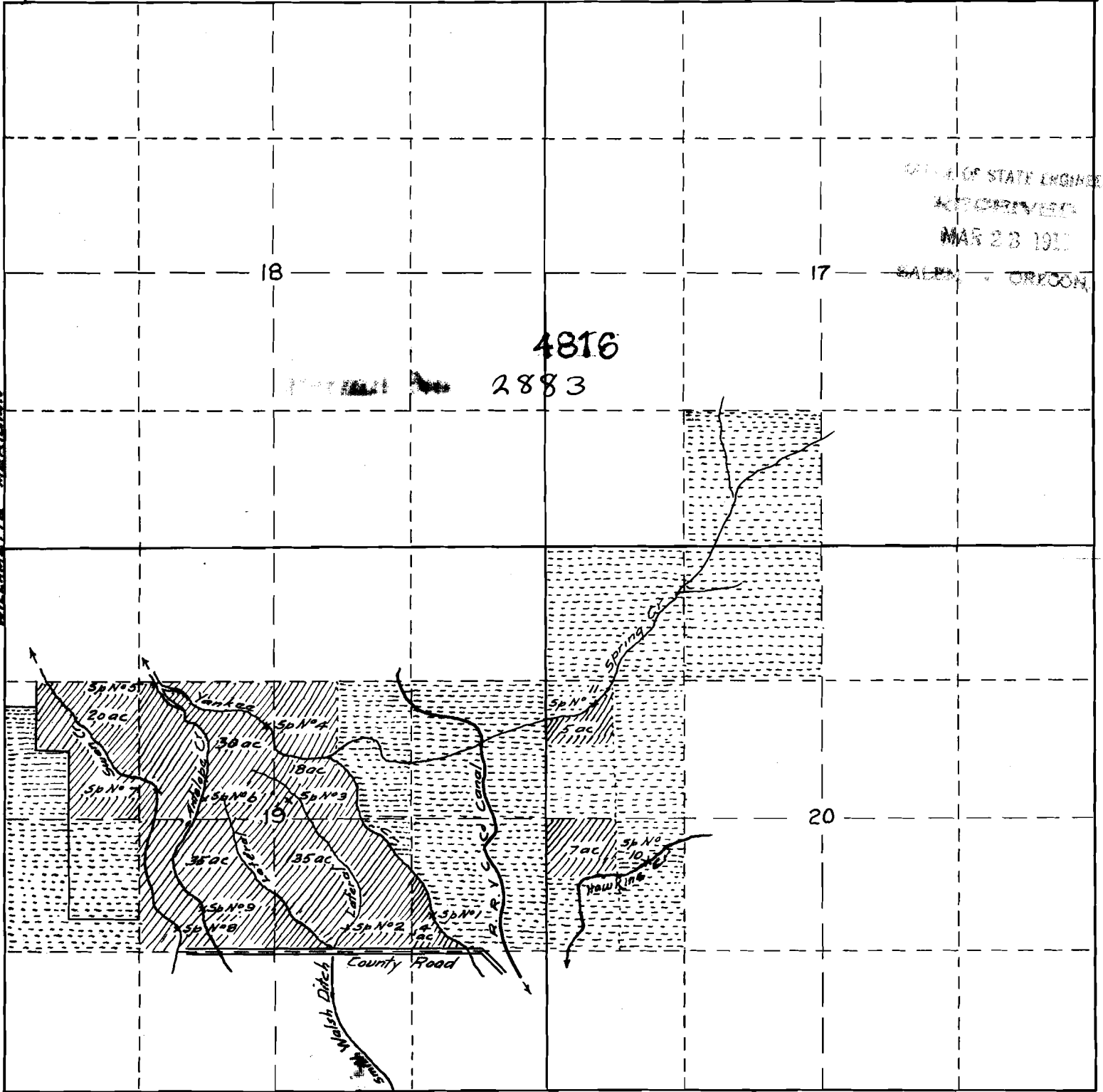

- Lands owned
- Lands to be irrigated

Map made from notes and plat of
the Company's Lands.

— Fred N. Cummings, C.E. —
Medford, Oregon.

7219