

T. 3 S. R. 1 W. W.M.

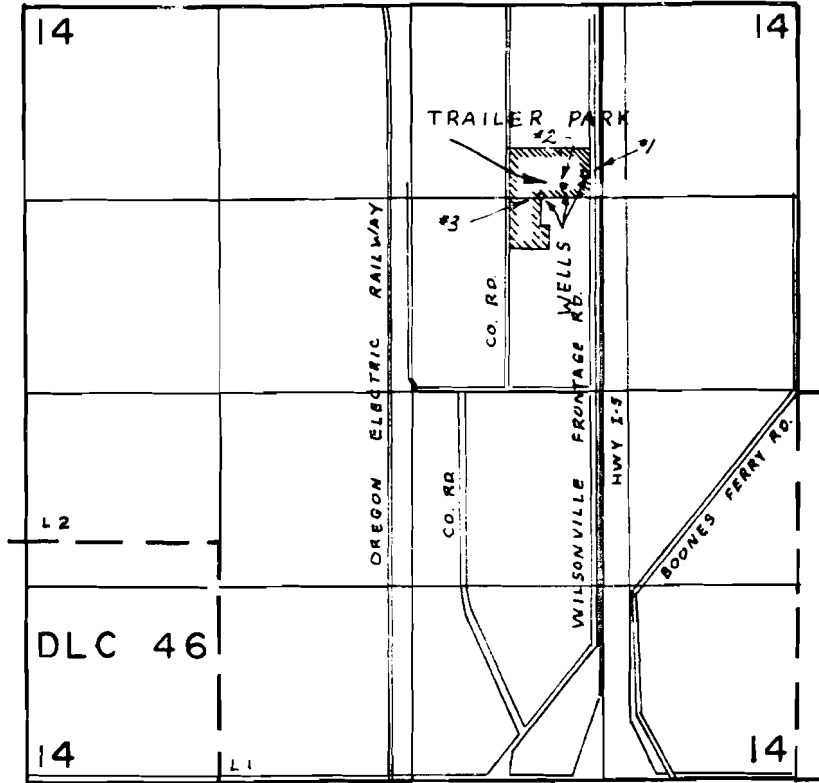

WELLS LOC: #1 - 1150'S. & 1450'W ; ALL FROM N.E. COR. SEC. 14
#2 - 1240'S & 1610'W
#3 - 1300'S & 1700'W

Application No. G-7495
Permit No. G 6071

FINAL PROOF SURVEY
UNDER

Application No. G-4669 Permit No. G-4393
IN NAME OF

VIRGIL M. & M. LORENE LISK

Surveyed AUG. 14. 1974. by L.H. NUNN.....