

# T5S. RIE. WM.

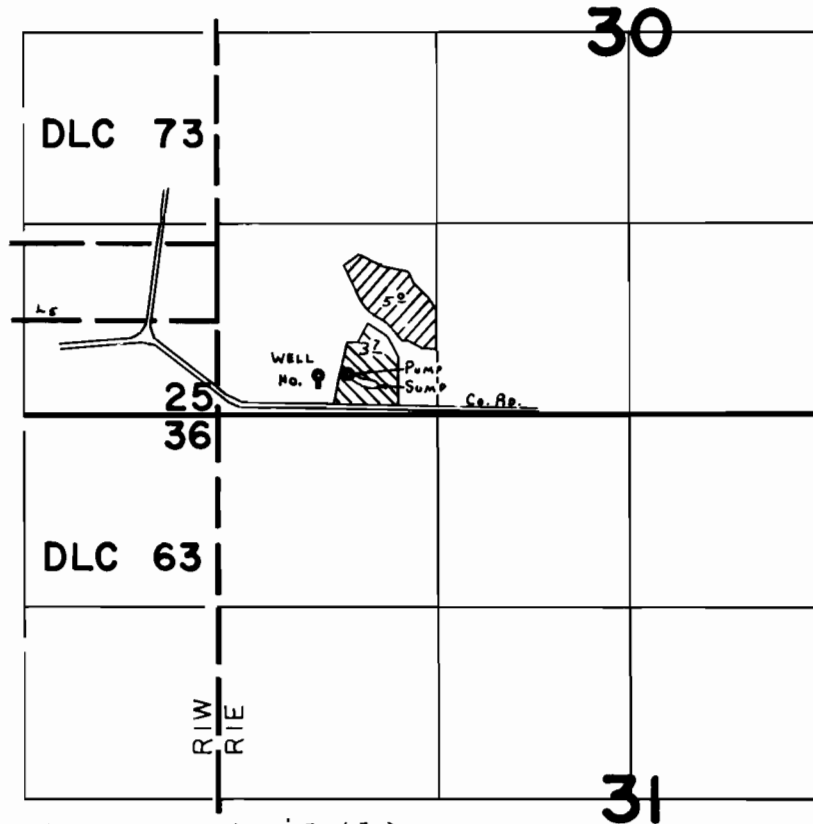

WELL LOC: 270' N. { 700' E. }  
 SUMP LOC: 280' N. { 910' E. } BOTH FROM S.W. COR. SEC. 30.

- IRR. FR. SUMP.
- IRR. FR. WELL.

## FINAL PROOF SURVEY UNDER

Application No. G-8509 Permit No. G-7793  
 IN NAME OF

WILLIAM J. DAHLSEID

Surveyed JUL. 31. 1978, by C. L. HUGHES