

T4 & 5S. R2E. WM.

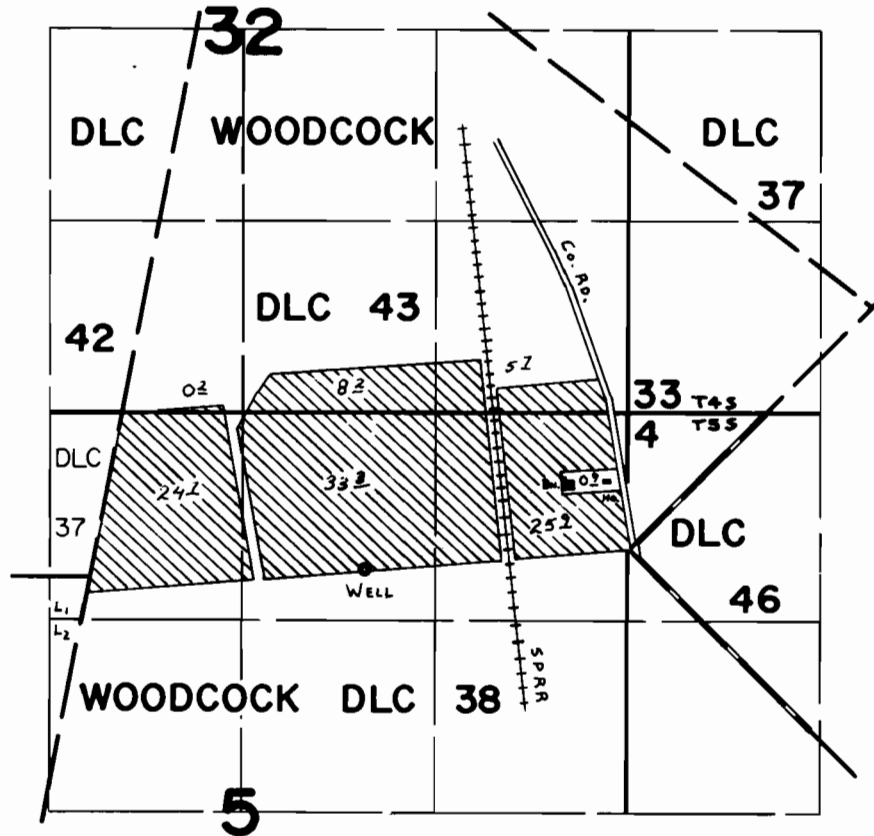

WELL LOC: 150'S. & 1800' W. FR. MOST WESTERLY COR. JACKSON DLC 46.

FINAL PROOF SURVEY UNDER

Application No. G-8682 Permit No. G-8018
IN NAME OF

RICHARD MOORHOUSE

Surveyed AUG. 1, 1978, by C. L. HUGHES