

T23S. R31E. WM.

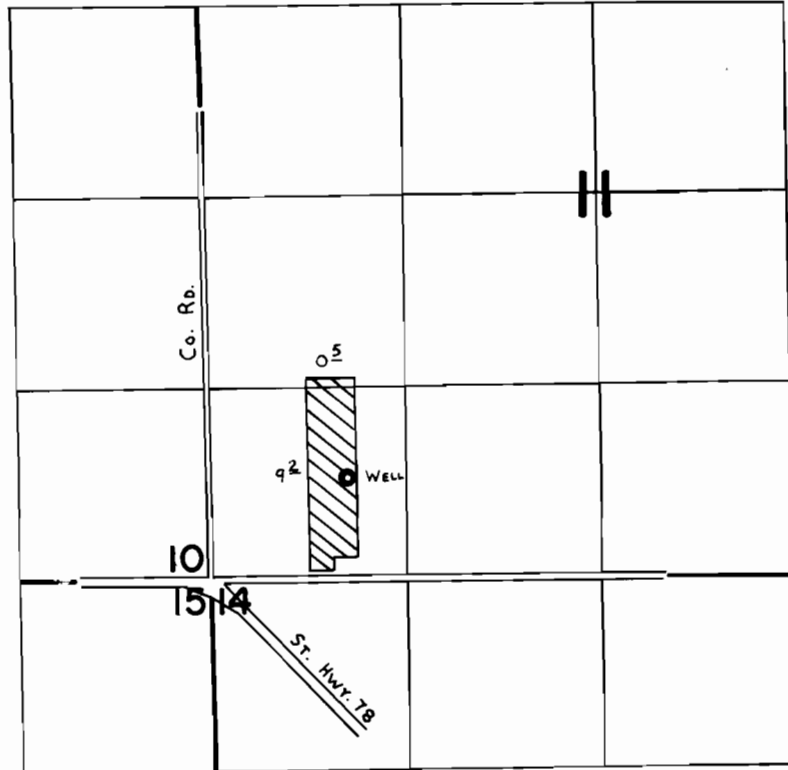

WELL Loc: 690' N. & 950' E. fr. S.W. COR. SEC. 11.

FINAL PROOF SURVEY UNDER

Application No. G-8113 Permit No. G-7691
IN NAME OF

LEON E. EVERHART

Surveyed AUG. 25 19 78, by C. L. HUGHES