

T. 35 S., R. 3 W., W.M.

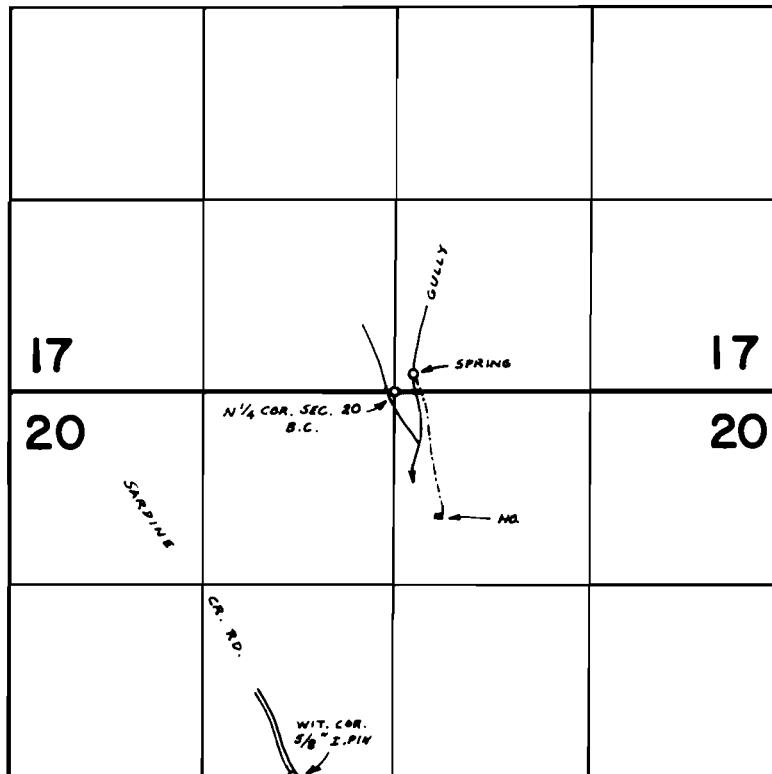

SPRING LOC. : 110' N. & 110' E. FROM S¹/₄ COR. SEC. 17

FINAL PROOF SURVEY UNDER

Application No. 50728 Permit No. 38315
IN NAME OF

RICHARD P. FALTERSACK

Surveyed SEPT. 19 78 by B. SUND
19....., by