

39088
50602

T40S. R18 & 19E. WM.

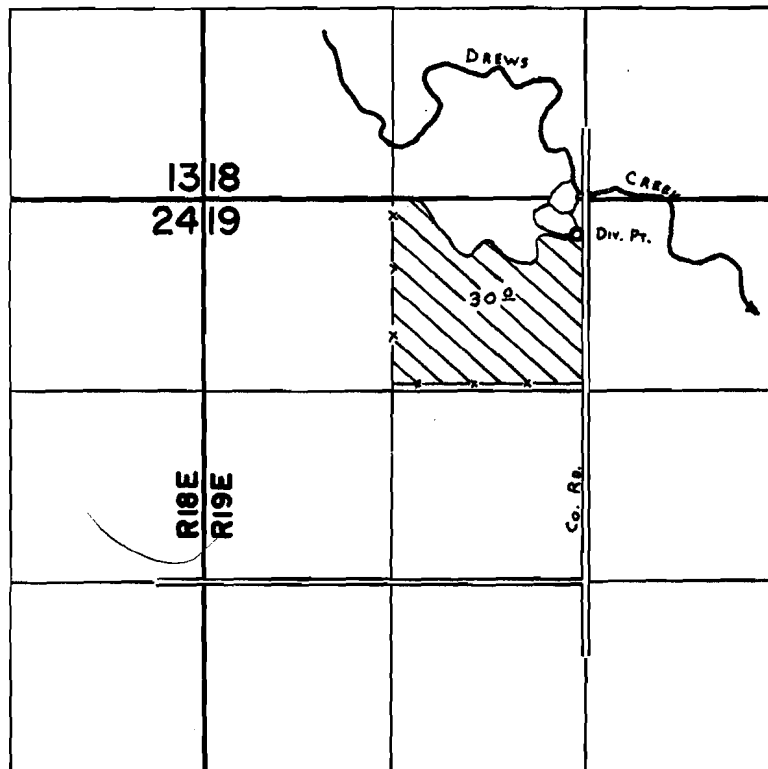

DIV. PT. LOC.: 240' S. $\frac{1}{2}$ 70' W. fr. N. $\frac{1}{4}$ COR. SEC. 19.

FINAL PROOF SURVEY UNDER

Application No. 51968 Permit No. 39088

IN NAME OF

KAY C. CLARK

Surveyed JUNE 23 1978 by C. L. HUGHES